

I-94 INTERCHANGE (EXIT 161) RECONSTRUCTION PROJECT

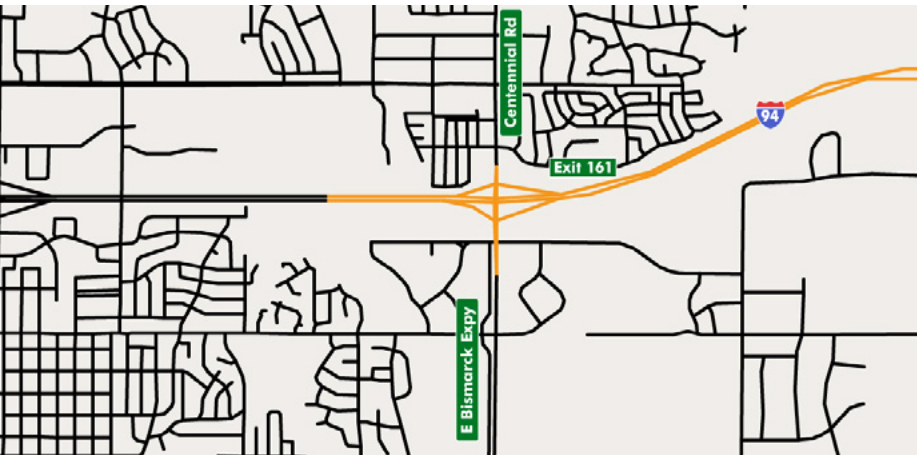

ISSUE 11: JULY 2024

EXPECT INTERSTATE LANE CLOSURES



Beginning Wednesday, July 31, the driving (right) lanes of eastbound and westbound Interstate 94 will be closed as construction crews tie temporary loop ramps into the existing interstate. The northbound right lane on Centennial Road/Bismarck Expressway will also be closed over the bridge. Speeds will be reduced in the work zone as workers remove concrete. This lane closure is expected to be in place through the end of the week. On and off-ramps at Exit 161 will remain accessible. Motorists should be prepared for delays in the work zone. The lane closures will be one mile in length.

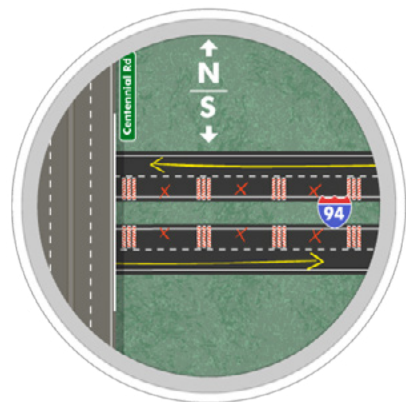
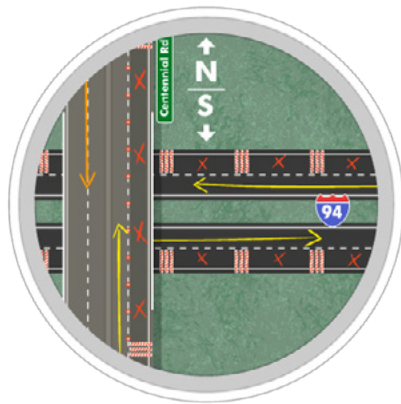

Starting Monday, August 5, lane closures will switch to the passing (left) lanes as crews set up temporary jersey barriers for additional work in the median. Heavy equipment will be used to construct a pier for the new interchange bridge.

CONSTRUCTION PROGRESS UPDATE

We've made significant progress with the first few months of construction on the new Exit 161 interchange.

- The NE and SE temporary ramp embankments have been completed and prepared for paving.
- The NW and SW bridge abutment embankments are complete, as crews look to begin driving pilings for bridge piers.
- Utilities and high-mast lighting have been relocated.



From the SE, looking at the two temporary loop ramps before paving

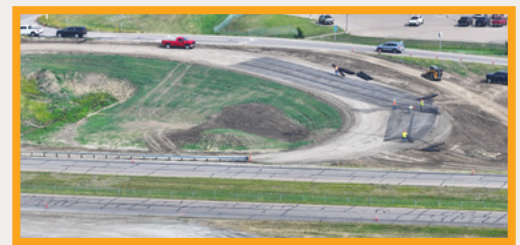

From the SE, crews preparing temporary loop ramps.



From SW, looking at the NW bridge abutment embankment.

MORE QUESTIONS?

Stay updated through this project's dedicated [webpage](#) or send your questions to our Bismarck District Office.

Dean Schloss, NDDOT Bismarck Assistant District Engineer | dschloss@nd.gov