

CHEVRON INSTALLATION DETAILS

D-754-79

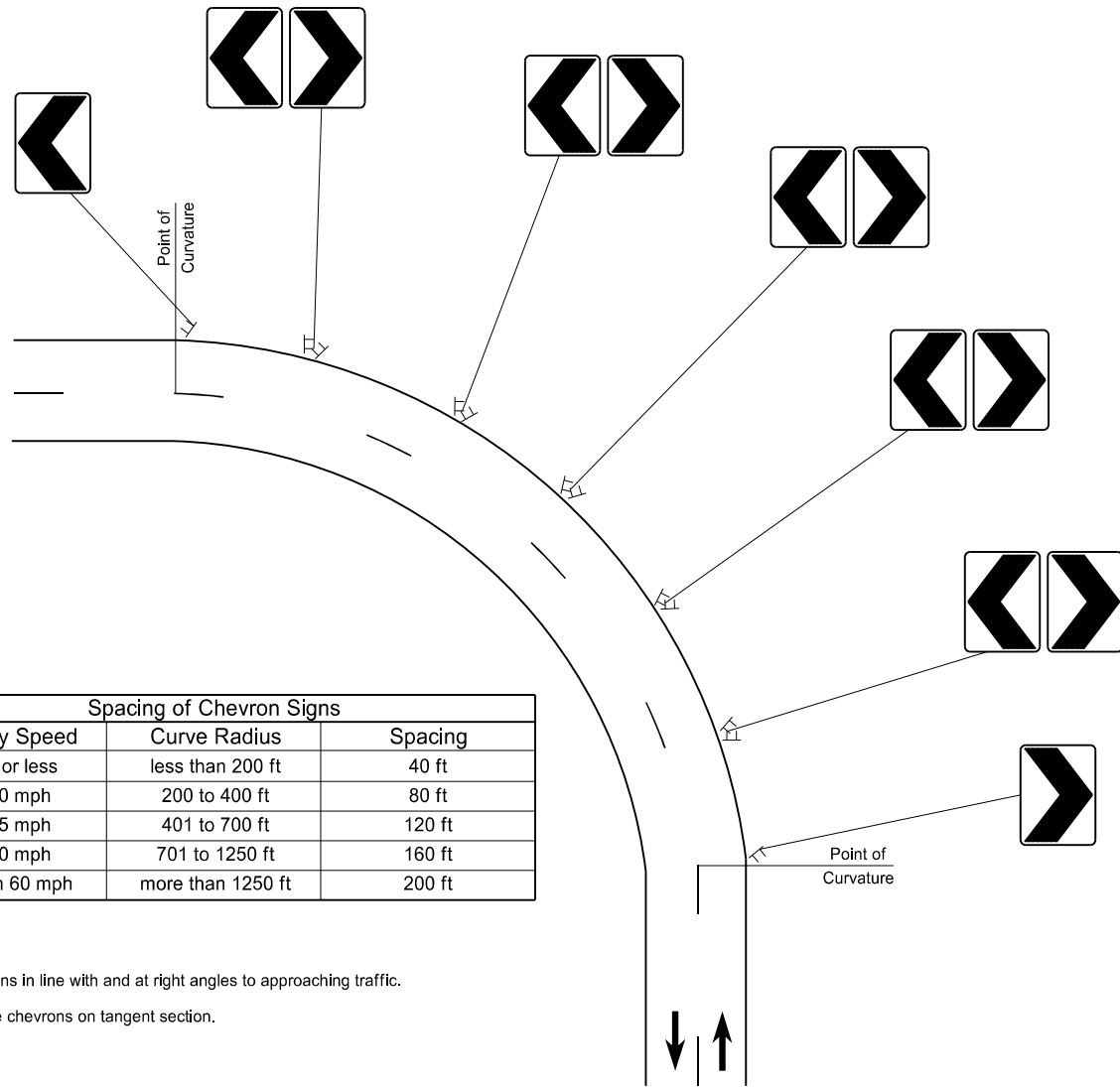

Spacing of Chevron Signs		
Advisory Speed	Curve Radius	Spacing
15 mph or less	less than 200 ft	40 ft
20 to 30 mph	200 to 400 ft	80 ft
35 to 45 mph	401 to 700 ft	120 ft
50 to 60 mph	701 to 1250 ft	160 ft
more than 60 mph	more than 1250 ft	200 ft

- Notes:
- Align chevrons in line with and at right angles to approaching traffic.
 - Do not place chevrons on tangent section.

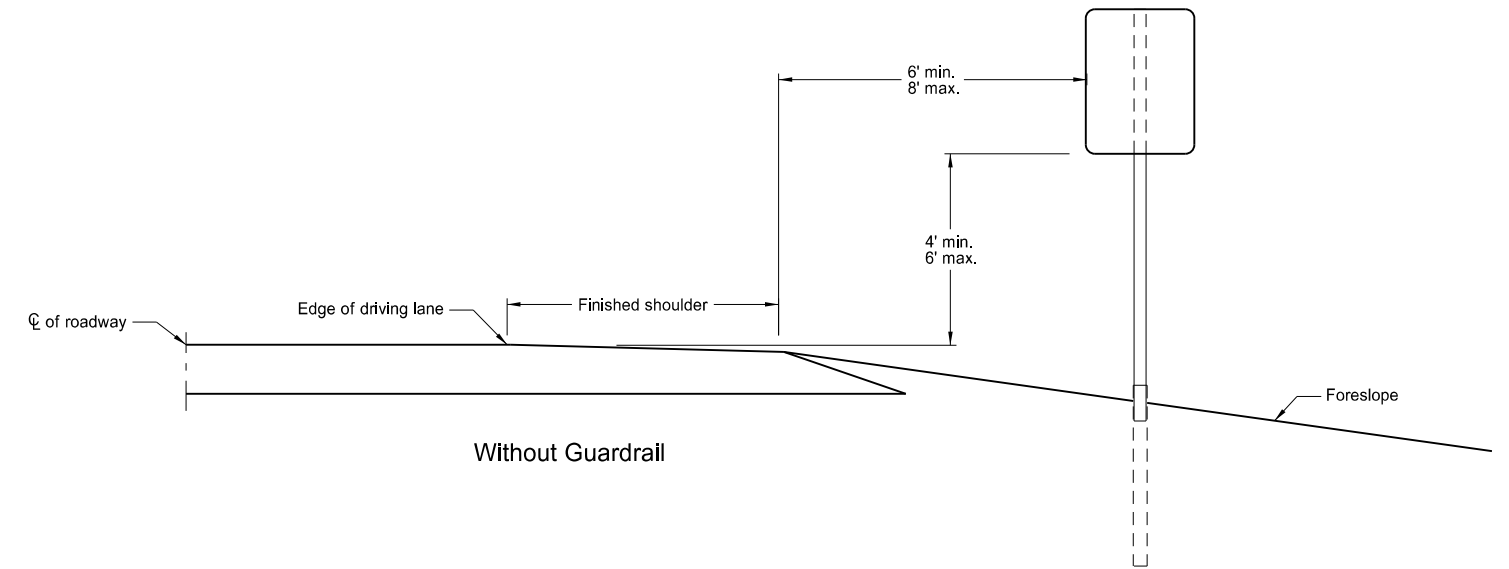

Without Guardrail

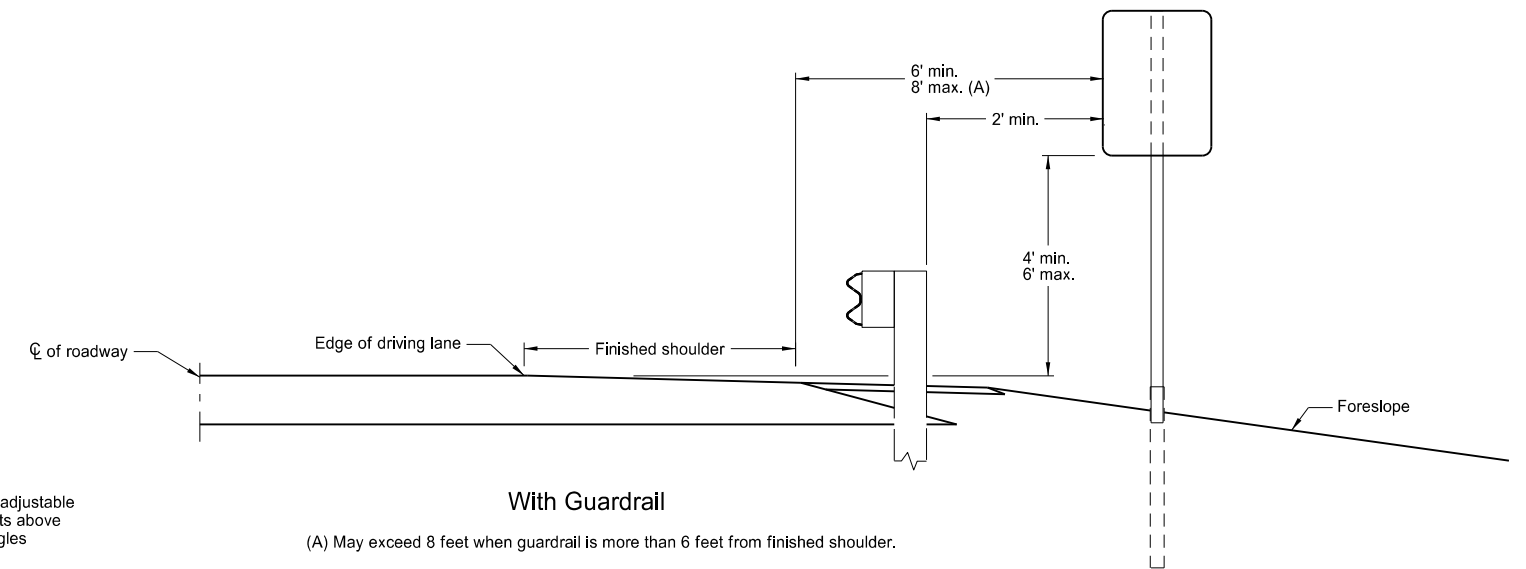

With Guardrail

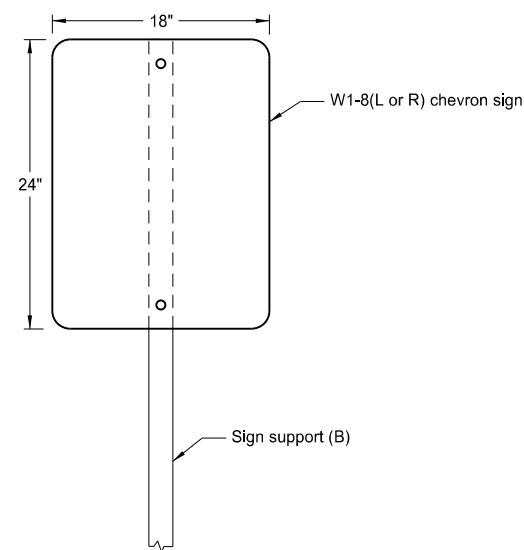

Chevron Single Sign Assembly

(B) Use 2x2x12ga. perforated tube single sign support and 2.25x2.25x12ga. perforated tube anchor unit.

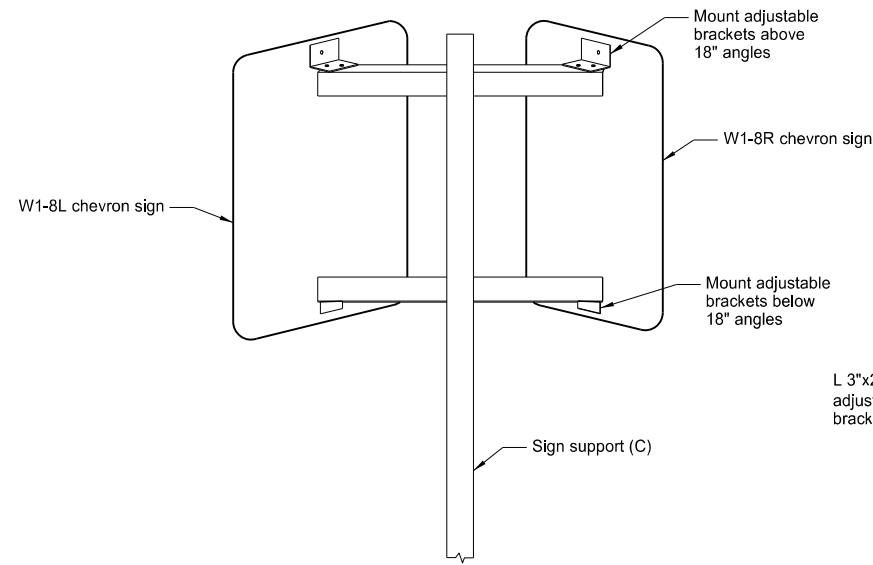

Chevron Double Sign Assembly

(C) Use 2.25x2.25x12ga. perforated tube double sign support and 2.5x2.5x12ga. perforated tube anchor unit.

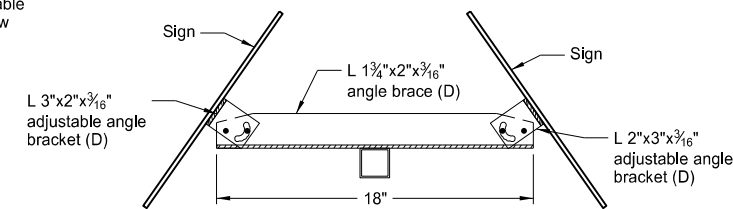

Top View

(D) Use aluminum or steel angles. Sizes are minimums, use larger sizes only when approved by the Engineer.

NORTH DAKOTA DEPARTMENT OF TRANSPORTATION	
10-10-13	
REVISIONS	
DATE	CHANGE
8-30-18	Updated notes to active voice.
9-05-19	New Design Engineer PE Stamp.

This document was originally issued and sealed by
 Kirk J Hoff,
 Registration Number
 PE- 4683,
 on 9/05/19 and the original document is stored at the North Dakota Department of Transportation