

SIGN PUNCHING, STRINGER AND SUPPORT LOCATION DETAILS  
REGULATORY, WARNING AND GUIDE SIGNS

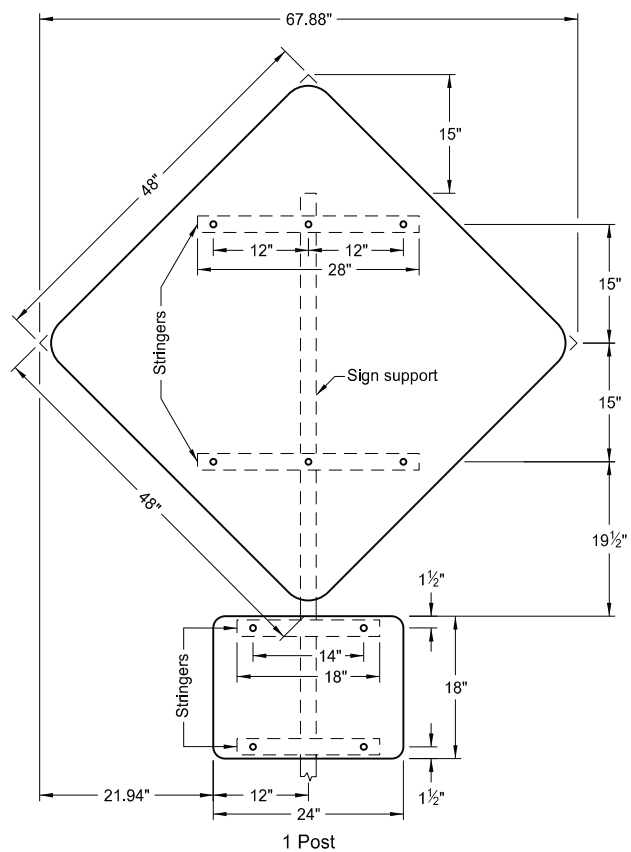

1 Post

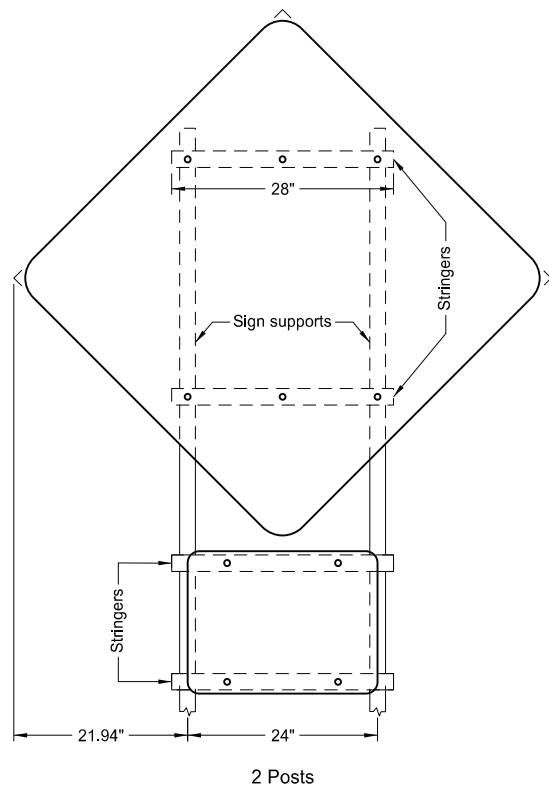

2 Posts

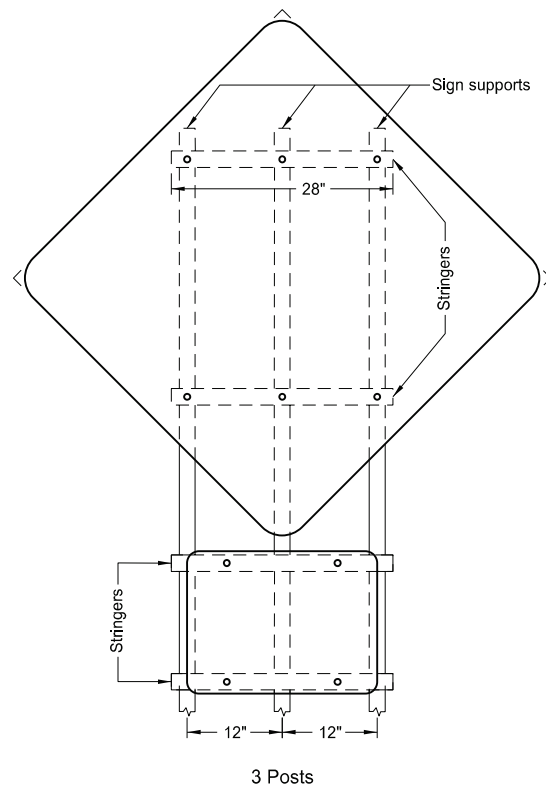

3 Posts

ASSEMBLY NO. 58

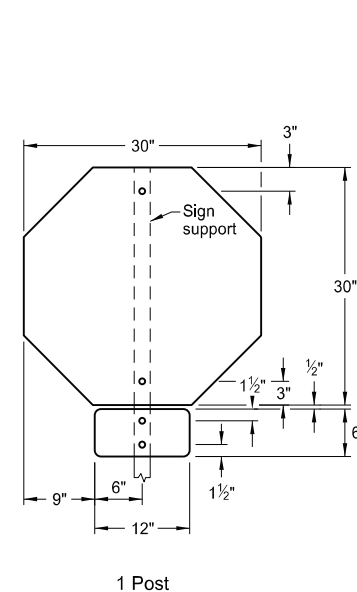

1 Post

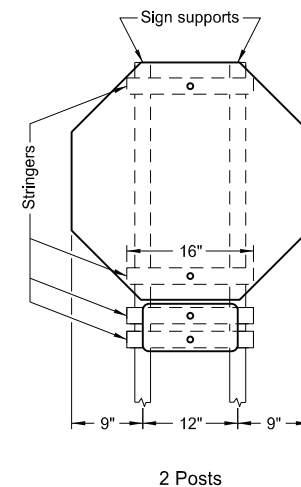

2 Posts

ASSEMBLY NO. 59

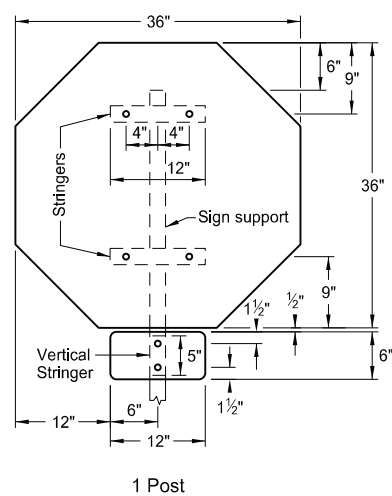

1 Post

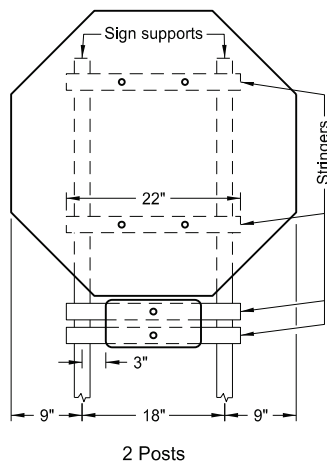

2 Posts

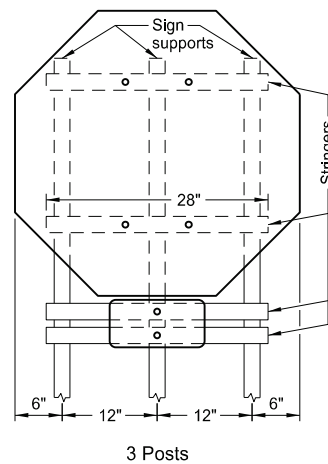

3 Posts

ASSEMBLY NO. 60

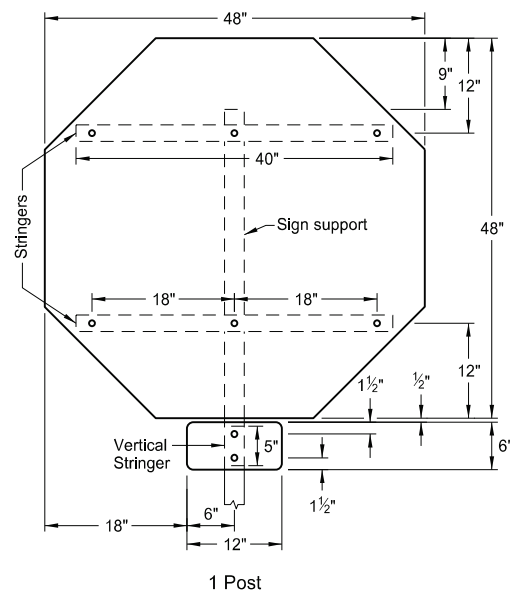

1 Post

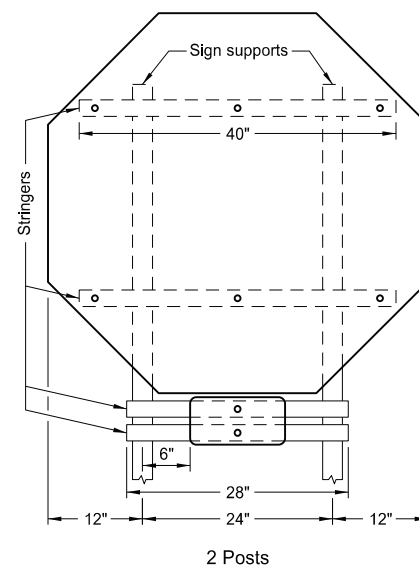

2 Posts

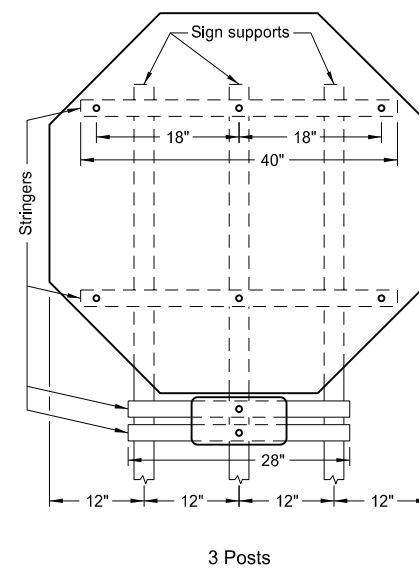

3 Posts

ASSEMBLY NO. 61

Notes:

1. Use 0.100 inch minimum thickness sign backing material.
2. Use 1 1/2"x1 1/2" perforated square tube stringers.
3. Punch holes round for 3/8" bolt.

NORTH DAKOTA DEPARTMENT OF TRANSPORTATION	
8-22-12	
REVISIONS	
DATE	CHANGE
8-30-18	Updated to active voice & added Assembly 58 dimension.
8-30-19	New Design Engineer PE Stamp.
8-06-24	Electronic Stamp/Signature.



08/06/24