

SIGN PUNCHING, STRINGER AND SUPPORT LOCATION DETAILS
REGULATORY, WARNING AND GUIDE SIGNS

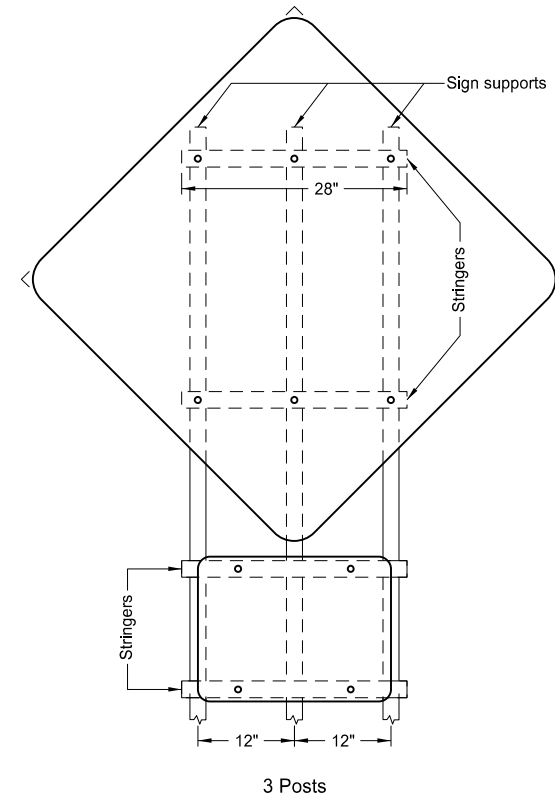

ASSEMBLY NO. 58

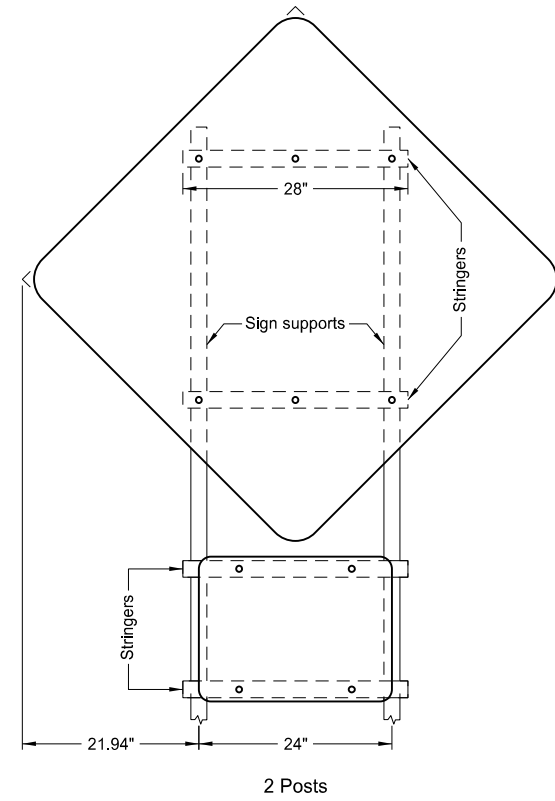
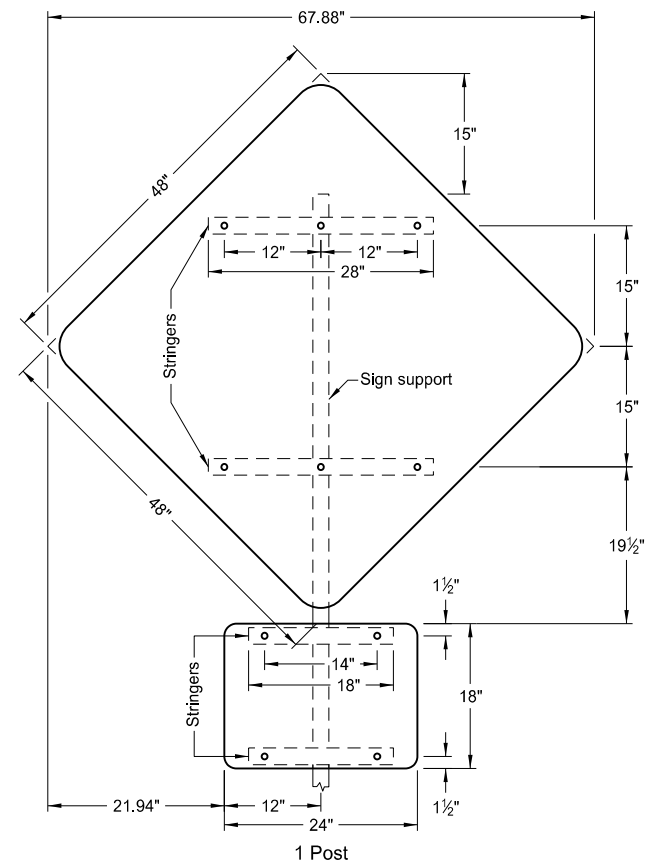
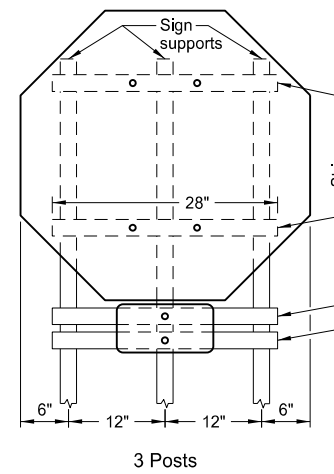
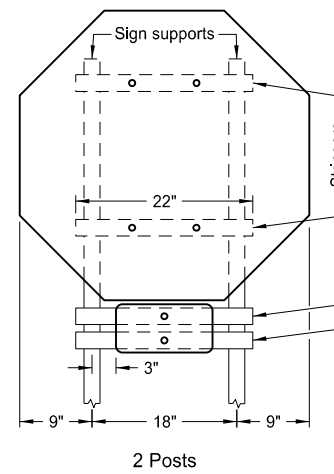
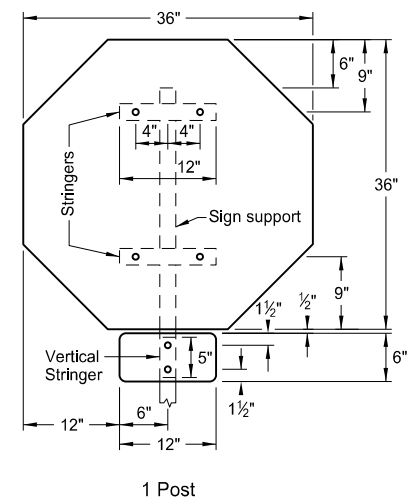

ASSEMBLY NO. 60

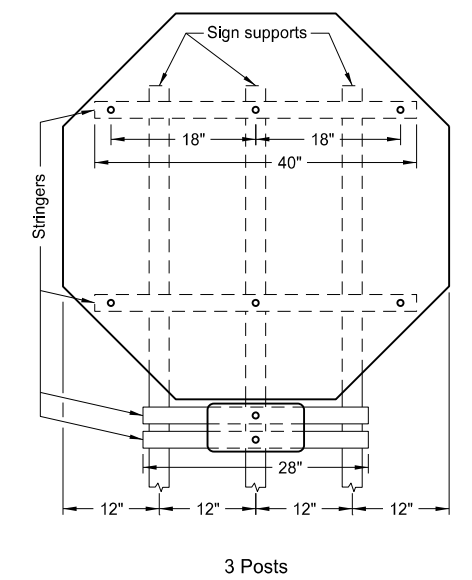
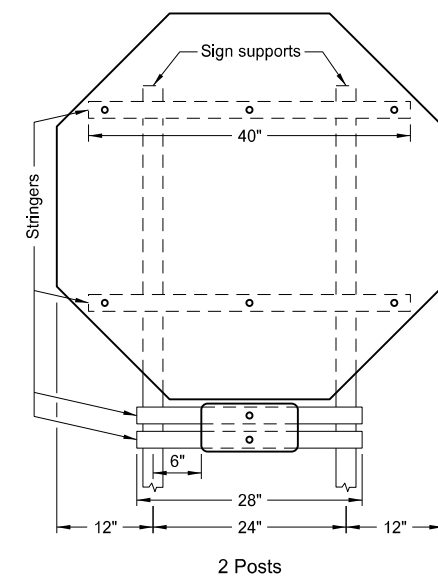
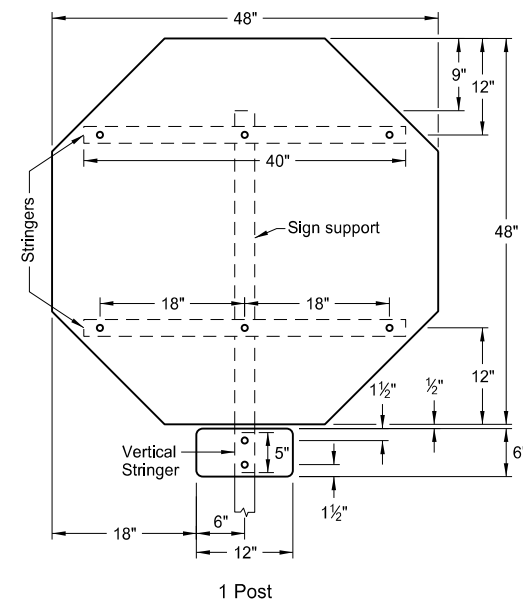

ASSEMBLY NO. 61

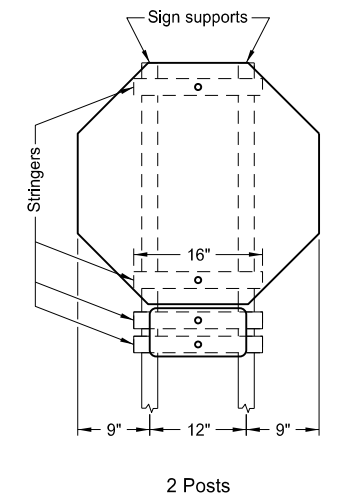
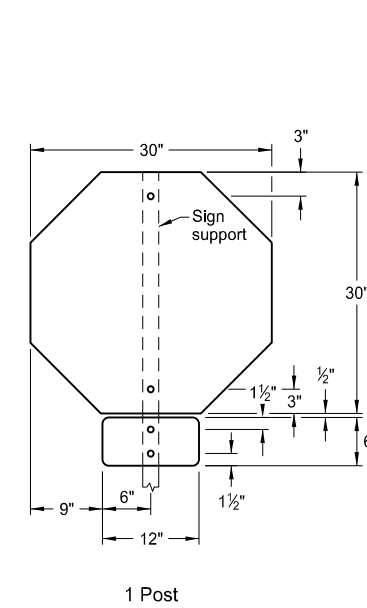

ASSEMBLY NO. 59

Notes:

1. Use 0.100 inch minimum thickness sign backing material.
2. Use 1 1/2"x1 1/2" perforated square tube stringers.
3. Punch holes round for 3/8" bolt.

NORTH DAKOTA DEPARTMENT OF TRANSPORTATION	
8-22-12	
REVISIONS	
DATE	CHANGE
8-30-18	Updated to active voice & added Assembly 58 dimension.
8-30-19	New Design Engineer PE Stamp.

This document was originally issued and sealed by
Kirk Hoff,
Registration Number
PE- 4683,
on 8/30/19 and the original document is stored at the North Dakota Department of Transportation