

SIGN PUNCHING, STRINGER AND SUPPORT LOCATION
DETAILS REGULATORY, WARNING AND GUIDE SIGNS

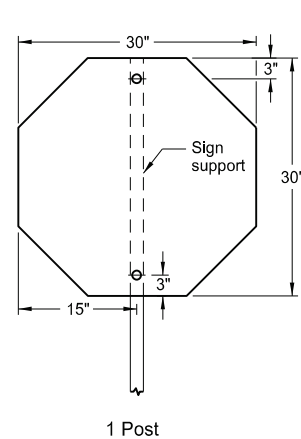

1 Post

Assembly No. 1

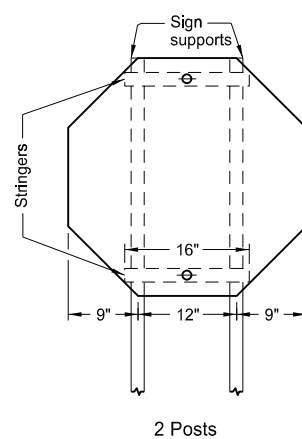

2 Posts

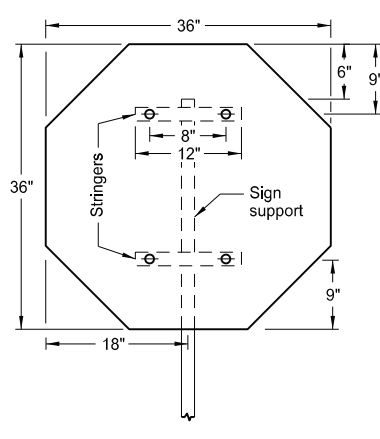

1 Post

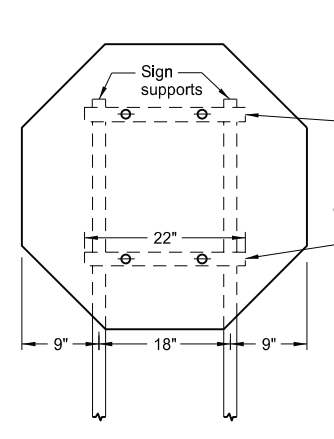

2 Posts

Assembly No. 2

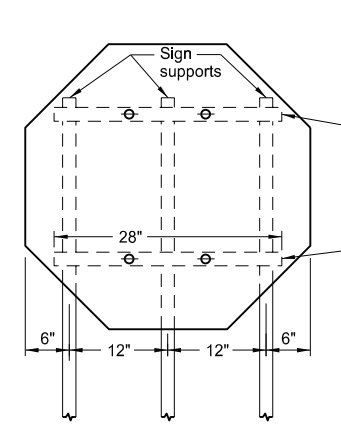

3 Posts

Notes:

1. Use 0.100 inch minimum thickness sign backing material.
2. Use 1 1/2" x 1 1/2" perforated square tube stringers.
3. Punch holes round for 3/8" bolt.

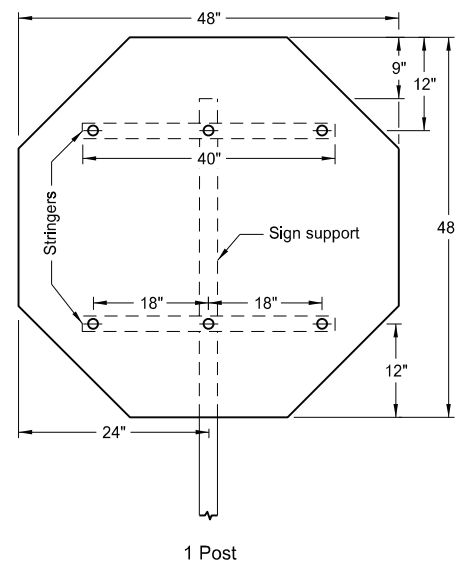

1 Post

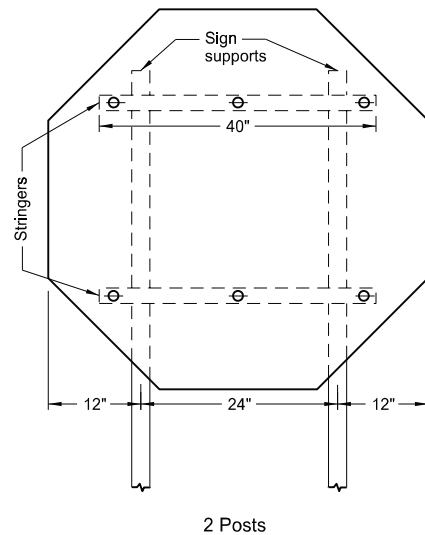

2 Posts

Assembly No. 3

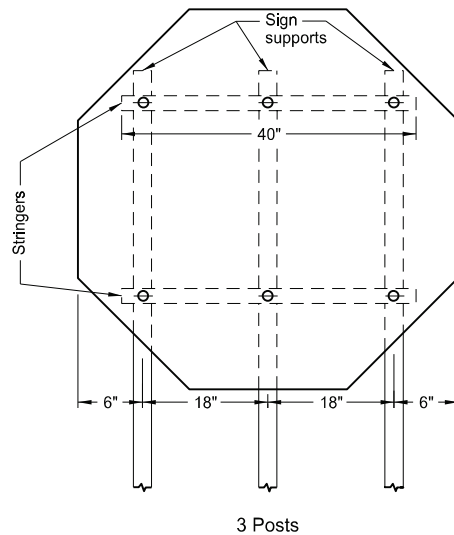

3 Posts

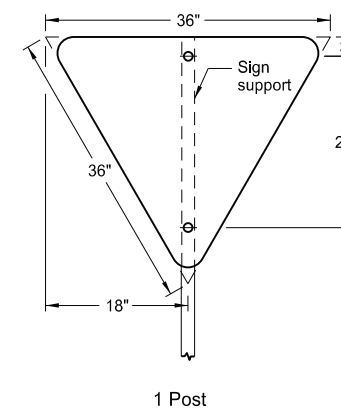

1 Post

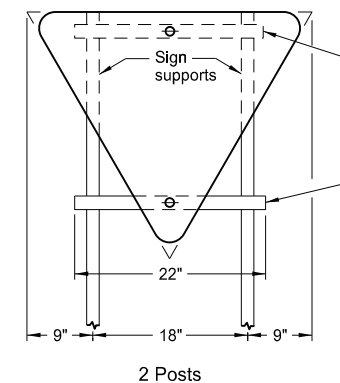

2 Posts

Assembly No. 4

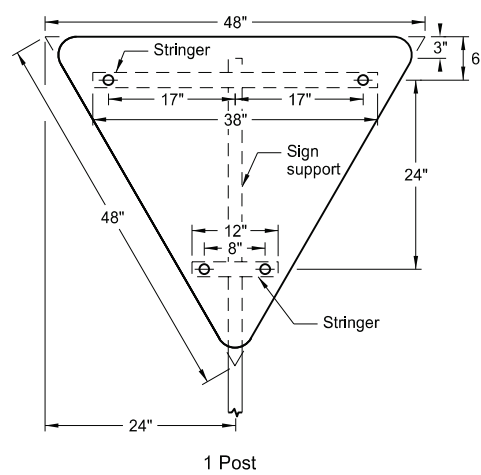

1 Post

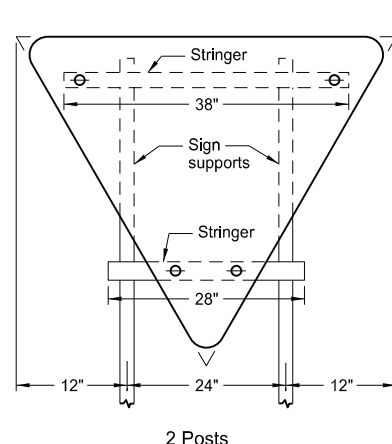

2 Posts

Assembly No. 5

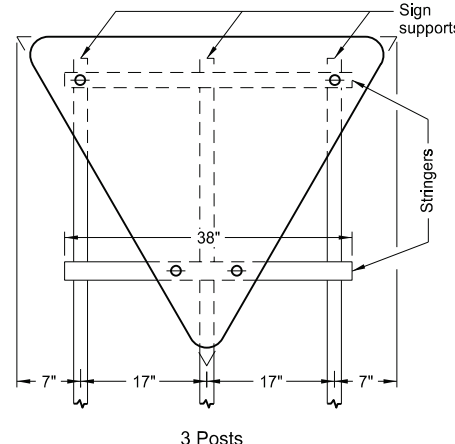

3 Posts

NORTH DAKOTA DEPARTMENT OF TRANSPORTATION	
12-1-10	
REVISIONS	
DATE	CHANGE
8-30-18	Updated notes to active voice,
8-30-19	New Design Engineer PE Stamp,
8-05-24	Electronic Stamp/Signature.

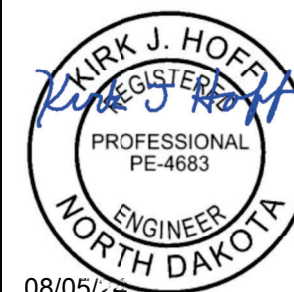

08/05/24