

2007 FUNCTIONAL CLASSIFICATION

NAME AND LOCATION OF ORGANIZED CIVIL TOWNSHIPS THOSE UNORGANIZED ARE SO NOTED

- T. 158 N. - R. 64 W. KLINGSTRUP
- T. 158 N. - R. 63 W. ROYAL
- T. 158 N. - R. 62 W. NORTHFIELD
- T. 158 N. - R. 61 W. PROSPECT
- T. 158 N. - R. 60 W. HIGHLAND CENTER
- T. 157 N. - R. 64 W. HAMMER
- T. 157 N. - R. 63 W. SULLIVAN
- T. 157 N. - R. 62 W. OVERLAND
- T. 157 N. - R. 61 W. FANCHER
- T. 156 N. - R. 60 W. NEVILAND
- T. 156 N. - R. 66 W. CHAIN LAKES
- T. 156 N. - R. 65 W. DE GROAT
- T. 156 N. - R. 64 W. WEBSTER
- T. 156 N. - R. 63 W. HARDING
- T. 156 N. - R. 62 W. CATO
- T. 156 N. - R. 61 W. TRIUMPH
- T. 156 N. - R. 60 W. LAWTON
- T. 155 N. - R. 66 W. COLLEE
- T. 155 N. - R. 65 W. DRY LAKE
- T. 155 N. - R. 64 W. FRESHWATER
- T. 155 N. - R. 63 W. MORRIS
- T. 155 N. - R. 62 W. NOONAN
- T. 155 N. - R. 61 W. NEWBRE
- T. 155 N. - R. 60 W. LILJEHOFF
- T. 154 N. - R. 66 W. PELICAN
- T. 154 N. - R. 65 W. GRAND HARBOR
- T. 154 N. - R. 64 W. POPP AR GROVE
- T. 154 N. - R. 63 W. CREEL
- T. 154 N. - R. 62 W. ONTARIO
- T. 154 N. - R. 61 W. NIXON
- T. 154 N. - R. 60 W. MINNEWAUKAN
- T. 153 N. - R. 63 W. SOUTH MINNEWAUKAN
- T. 153 N. - R. 62 W. STEVENS
- T. 153 N. - R. 61 W. BARTLETT
- T. 152 N. - R. 65 W. GRAND HARBOR
- T. 152 N. - R. 63 W. ODESSA
- T. 152 N. - R. 62 W. ODESSA
- T. 151 N. - R. 62 W. ODESSA

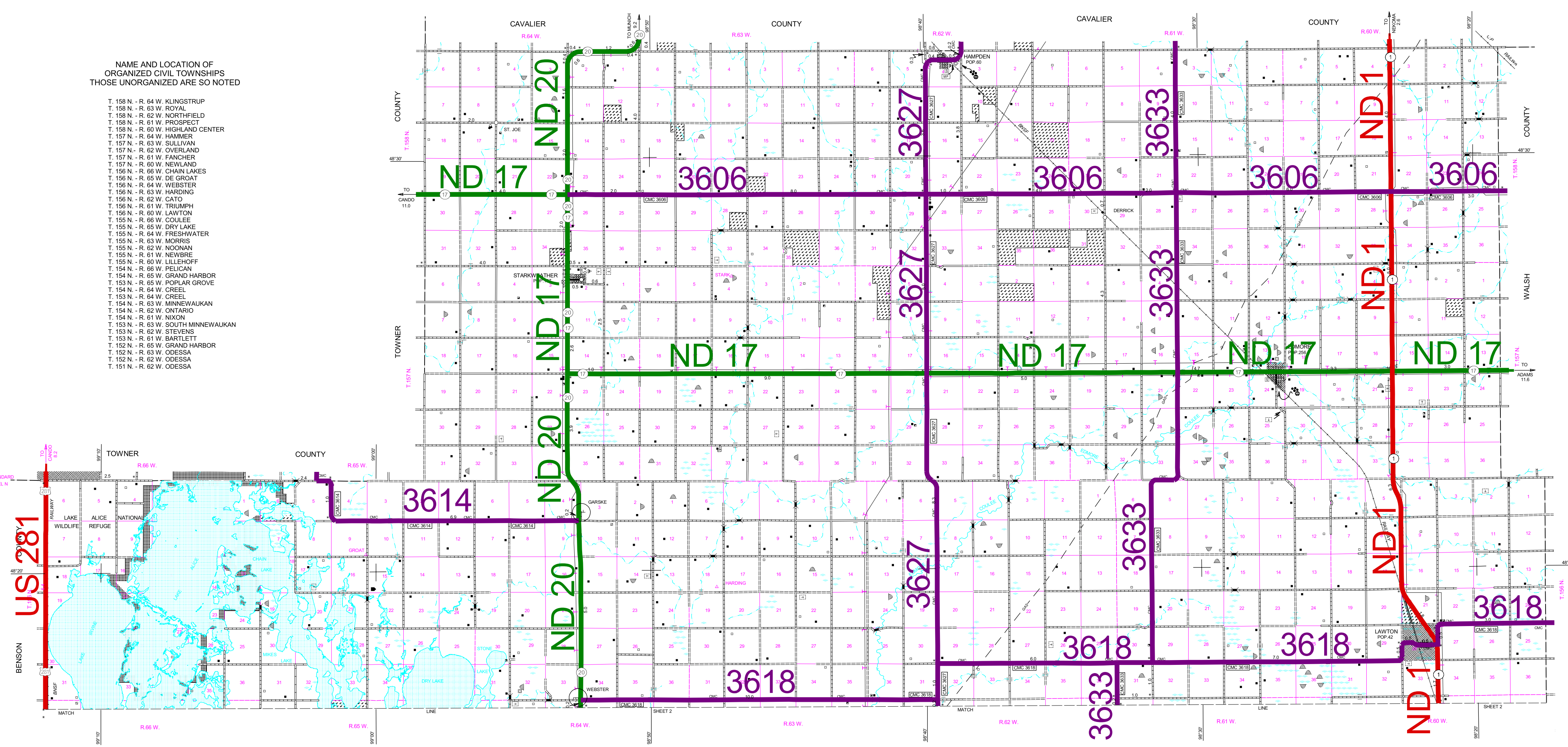

| GENERAL LEGEND | |
|---|---|
| ROADS AND ROADWAY FEATURES | BOUNDARIES |
| PRIMITIVE ROAD | STATE OR PROVINCE LINE |
| UNIMPROVED ROAD | COUNTY LINE |
| GRAVEL GRADED AND DRAINED ROAD | TOWNSHIP LINE |
| PAVED ROAD | CORPORATE LINE |
| DIVIDED HIGHWAY | SECTION LINE |
| STREETS IN UNINCORPORATED TOWNS | MATCH LINE BETWEEN ADJOINING SHEETS OF SAME COUNTY |
| COUNTY MAJOR COLLECTOR | BOUNDARY TO MARK ENLARGEMENT INSET |
| ROUTE NUMBER | NATIONAL PARKS, REFUGES, AND OTHER RESERVATIONS |
| POINTS BETWEEN WHICH DISTANCES ARE MEASURED | WILDLIFE MANAGEMENT AREA |
| INTERSTATE NUMBERED HIGHWAY | MONUMENT - SMALL, HISTORIC SITE |
| U.S. NUMBERED HIGHWAY | WILDLIFE PRODUCTION AREA |
| STATE HIGHWAY SYSTEM | STATE PARKS |
| | STATE SCHOOL LAND |
| AIRPORTS | INDUSTRIAL |
| AIRFIELD, LIMITED FACILITIES | STORE OR SMALL BUSINESS ESTABLISHMENT |
| LANDING AREA OR STRIP | BUSINESS AND POST OFFICE |
| RAILROADS | GAS TANK |
| RAILROAD (ANY NUMBER OF TRACKS USED BY A SINGLE OPERATING CO.) | GROUP OF STORAGE TANKS (OIL OR GAS) |
| RAILROAD STATION | FILLING STATION |
| RAILROAD GRADE CROSSING | WAREHOUSE - GENERAL |
| RAILROAD ABOVE | GRAIN ELEVATOR |
| RAILROAD BELOW | STOCK YARD - LOADING PEN OR CORRAL |
| DRAINAGE | GRAVEL PIT |
| INTERMITTENT STREAM (NARROW) | VALVE HOUSE |
| NARROW STREAM | FARM UNITS, DWELLINGS, ETC. |
| WIDE STREAM | FARM UNIT (FARM UNITS SHOWN IN MUNICIPAL LIMITS INDICATE FARM BUILDINGS FOR FARM USE) |
| WIDE STREAM WITH DAM | DWELLING OTHER THAN FARM |
| LAKE, RESERVOIR, OR POND | ROWS OR GROUPS OF DWELLINGS CLOSELY SPACED (FIGURE DENOTES NUMBER OF DWELLINGS) |
| LAKE, RESERVOIR, OR POND WITH DAM | BARRACKS, OR DORMATORIES FOR STUDENTS, WORKERS, MIGRANTS, ETC. |
| MARSH OR SWAMP LAND | SEASONAL OR SUMMER COLONY |
| DRAINAGE DITCH | DWELLING |
| IRRIGATION DITCH | SEASONAL DWELLINGS CLOSELY SPACED |
| NAVIGATION | HOTEL OR INN |
| DOCK, PIER, OR LANDING | CHURCH |
| STRUCTURES | CEMETERY |
| HIGHWAY BRIDGE, GENERAL | CHURCH WITH CEMETERY ADJACENT |
| HIGHWAY GRADE SEPARATION | WELL |
| DAM WITH ROAD | TENANT HOUSE |
| MINOR DRAINAGE STRUCTURE | WATER STORAGE FOR FIRE PROTECTION |
| FORD - ROAD ESTABLISHED | PUBLIC SERVICE FACILITIES |
| CONSERVATION AND RECREATION | POST OFFICE |
| PICNIC GROUND | HIGHWAY GARAGE |
| PLAYGROUND, BALL FIELD, ETC. | GARAGE OR RUBBISH DUMP |
| BATHING BEACH OR SWIMMING POOL | SEWAGE DISPOSAL PLANT |
| SCENIC SITE | AUTOMOBILE GRAVEYARD |
| CAMP SITE, NO PERMANENCE (TENTS OR TRAILER PARKING) | PIPE LINE, GAS |
| CAMP OR LODGE (PERMANENT SITE WITH BUILDINGS) | PIPE LINE, OIL |
| REST AREA | TRANSMISSION LINE |
| SMALL PARK (SP-STATE, CP-COUNTY, MP-MUNICIPAL, WP-WAYSIDE PARK) | POWER SUBSTATION |
| GOLF GROUND OR COUNTRY CLUB | BOOSTER STATION |
| GUIDE HOUSE OR GATE HOUSE | COMMUNICATION TOWER |
| ARCHERY CLUB | MUNICIPAL BUILDING |
| RIFLE CLUB | MISCELLANEOUS |
| RIDING ACADEMY | TRIANGULATION STATION |
| CITY AND VILLAGE CENTERS | FORT, ARMY CAMP, BARRACKS, OR OTHER MILITARY POST |
| COUNTY SEAT | DOT TO INDICATE LOCATION OF ANY CULTURAL FEATURE SHOWN OUT OF POSITION |
| OTHER CITIES AND VILLAGES | ALL VACANT CULTURE INDICATED BY OPEN SYMBOL |
| INCORPORATED CITY OR VILLAGE (GENERALIZED) | LATITUDE AND LONGITUDE |
| EDUCATIONAL AND CORRECTIONAL INSTITUTIONS | |
| SCHOOLHOUSE | |
| TOWNHALL, GRANGE, OR COMMUNITY HALL | |

LEGEND

- PRINCIPAL ARTERIALS
- MINOR ARTERIALS
- MAJOR COLLECTORS

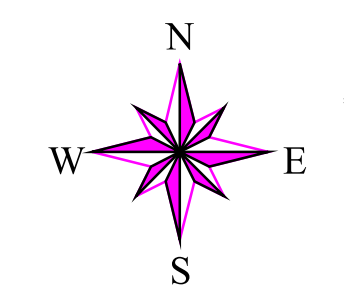

RAMSEY COUNTY NORTH DAKOTA

PREPARED BY THE
NORTH DAKOTA DEPARTMENT OF TRANSPORTATION
PLANNING AND PROGRAMMING DIVISION

IN COOPERATION WITH THE
U.S. DEPARTMENT OF TRANSPORTATION
FEDERAL HIGHWAY ADMINISTRATION

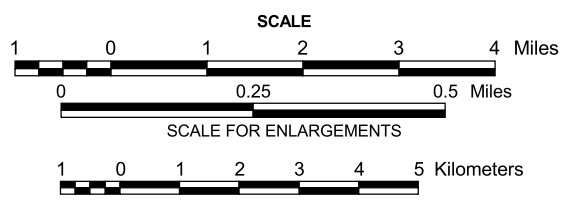

2006

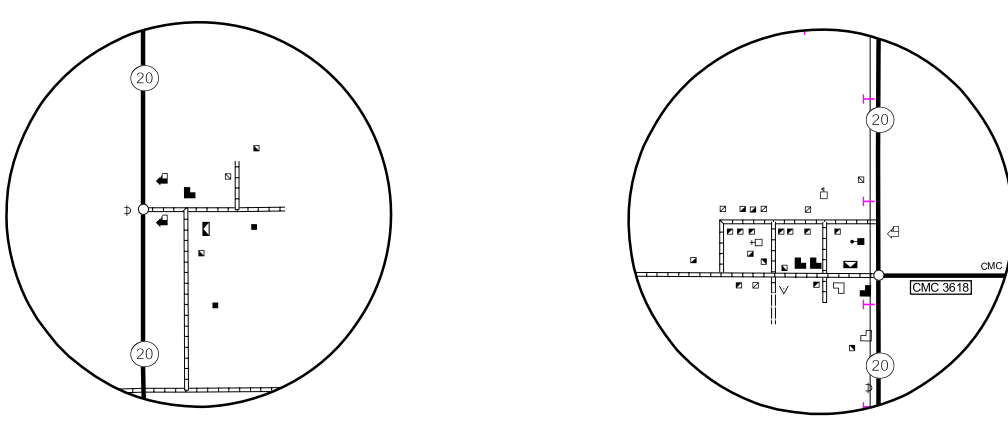

GARSKÉ
SECS. 3, 4, 9, & 10, T. 156 N., R. 64 W.

WEBSTER
SECS. 3 & 4, T. 155 N., R. 64 W.
SECS. 33 & 34, T. 156 N., R. 64 W.

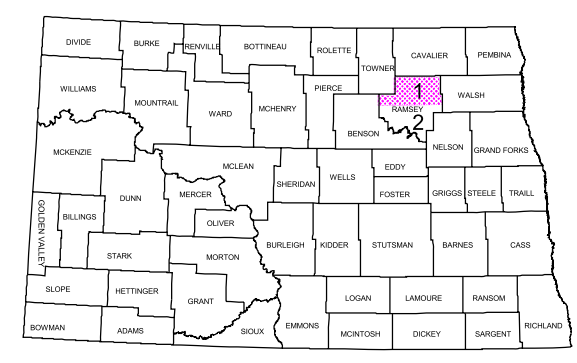

STATE OF NORTH DAKOTA
DIAGRAM OF COUNTIES

COPIES OF THIS MAP ARE AVAILABLE FOR PUBLIC USE AT A NOMINAL COST FROM:
MAP SALES, N.D. DEPT. OF TRANSPORTATION, 608 E. BLVD. AVE., BISMARCK, N.D. 58505-0700

BASED ON AERIAL PHOTOGRAPHY OF 1959
GROUND INVENTORY OF 2006
AERIAL INVENTORY OF 2006
UNIVERSAL TRANSVERSE MERCATOR ZONE 14
NORTH AMERICAN DATUM 83
SHEET 1 OF 2