

File:///c:/arview/stewarn/arcbook/.....

- NAME AND LOCATION OF ORGANIZED CIVIL TOWNSHIPS THOSE UNORGANIZED ARE SO NOTED
- T. 154 N.-R. 60 W. CLARA
 - T. 154 N.-R. 59 W. ENTERPRISE
 - T. 154 N.-R. 58 W. SARMA
 - T. 154 N.-R. 57 W. DAHLEN
 - T. 153 N.-R. 60 W. LAKOTA
 - T. 153 N.-R. 59 W. RUBIN
 - T. 153 N.-R. 58 W. MICHIGAN CITY
 - T. 152 N.-R. 58 W. MICHIGAN CITY
 - T. 152 N.-R. 57 W. NASH
 - T. 152 N.-R. 56 W. ILLINOIS
 - T. 152 N.-R. 60 W. DODDS
 - T. 152 N.-R. 59 W. WILLIAMS
 - T. 152 N.-R. 58 W. PETERSBURG
 - T. 152 N.-R. 57 W. PETERSBURG
 - T. 151 N.-R. 61 W. LEVAL
 - T. 151 N.-R. 60 W. WAMDUSKA
 - T. 151 N.-R. 59 W. CENTRAL
 - T. 151 N.-R. 58 W. MELVIN
 - T. 151 N.-R. 57 W. ADLER
 - T. 150 N.-R. 61 W. DAYTON
 - T. 150 N.-R. 60 W. CSAGO
 - T. 150 N.-R. 59 W. HAMLIN
 - T. 150 N.-R. 58 W. FIELD
 - T. 150 N.-R. 57 W. RUGH
 - T. 149 N.-R. 61 W. FORDE
 - T. 149 N.-R. 60 W. BERGEN
 - T. 149 N.-R. 59 W. NESHEIM
 - T. 149 N.-R. 58 W. LEE
 - T. 149 N.-R. 57 W. ORA

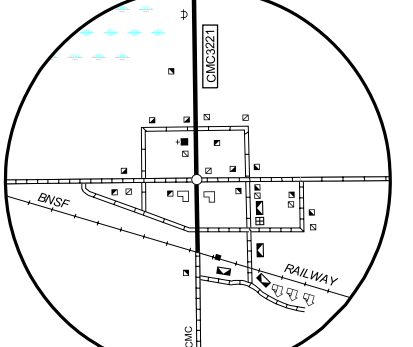

- ### LEGEND
- PRINCIPAL ARTERIALS
 - MINOR ARTERIALS
 - MAJOR COLLECTORS
- ### GENERAL LEGEND
- ROADS AND ROADWAY FEATURES**
- PRIMITIVE ROAD
 - UNIMPROVED ROAD
 - GRADED AND DRAINED ROAD
 - GRAVEL GRADED AND DRAINED ROAD
 - PAVED ROAD
 - DIVIDED HIGHWAY
 - STREETS IN UNINCORPORATED TOWNS
 - COUNTY MAJOR COLLECTOR ROUTE NUMBER
 - POINTS BETWEEN WHICH DISTANCES ARE MEASURED
 - INTERSTATE NUMBERED HIGHWAY
 - U.S. NUMBERED HIGHWAY
 - STATE HIGHWAY SYSTEM
- BOUNDARIES**
- COUNTY LINE
 - TOWNSHIP LINE
 - CORPORATE LINE
 - SECTION LINE
 - BOUNDARY TO MARK ENLARGEMENT INSET
 - NATIONAL PARKS, REFUGES, AND OTHER RESERVATIONS
 - MONUMENT - SMALL, HISTORIC SITE
 - WILDLIFE MANAGEMENT AREA
 - WATERFOWL PRODUCTION AREA
 - STATE PARKS
 - STATE SCHOOL LAND
- DRAINAGE**
- INTERMITTENT STREAM (NARROW)
 - NARROW STREAM
 - WIDE STREAM
 - WIDE STREAM WITH DAM
 - LAKE, RESERVOIR, OR POND
 - LAKE, RESERVOIR, OR POND WITH DAM
 - MARSH OR SWAMP LAND
- NAVIGATION**
- DOCK, PIER, OR LANDING
- STRUCTURES**
- HIGHWAY BRIDGE, GENERAL
 - HIGHWAY GRADE SEPARATION
 - DAM WITH ROAD
 - MINOR DRAINAGE STRUCTURE
- CONSERVATION AND RECREATION**
- PICNIC GROUND
 - PLAYGROUND, BALL FIELD, ETC.
 - CAMP SITE, NO PERMANENCE (TENTS OR TRAILER PARKING)
 - CAMP OR LODGE (PERMANENT SITE WITH BUILDINGS)
 - GOLF GROUND OR COUNTRY CLUB
 - AMUSEMENT PARK OR HALL
 - RIFLE CLUB
- NATURAL FEATURES**
- PROMINENT ELEVATION - WITH NAME
- RAILROADS**
- RAILROAD (ANY NUMBER OF TRACKS USED BY A SINGLE OPERATING CO.)
 - RAILROAD STATION
 - RAILROAD BELOW
- AIRPORTS**
- AIRFIELD, LIMITED FACILITIES
 - LANDING AREA OR STRIP
- EDUCATIONAL AND CORRECTIONAL INSTITUTIONS**
- TOWNHALL, GRANGE, OR COMMUNITY HALL
 - MUSEUM - GENERAL
 - CORRECTIONAL INSTITUTION
- PUBLIC SERVICE FACILITIES**
- POST OFFICE
 - HIGHWAY GARAGE
 - FIRE ENGINE HOUSE
 - GARBAGE OR RUBBISH DUMP
 - SEWAGE DISPOSAL PLANT
 - WATER SUPPLY STAND PIPE OR TANK
 - PIPE LINE, GAS
 - PIPE LINE, OIL
 - TRANSMISSION LINE
 - POWER SUBSTATION
 - COMMUNICATION TOWER
 - MUNICIPAL BUILDING
- INDUSTRIAL**
- STORE OR SMALL BUSINESS ESTABLISHMENT
 - GROUP OF STORAGE TANKS (OIL OR GAS)
 - GAUGING OR PUMPING STATION
 - WAREHOUSE - GENERAL
 - GRAIN ELEVATOR
 - GRAVEL PIT
 - NURSERY
 - WIND TURBINE
- FARM UNITS, DWELLINGS, ETC.**
- FARM UNIT (FARM UNITS SHOWN IN MUNICIPAL LIMITS INDICATE FARM BUILDINGS FOR FARM USE)
 - DWELLING OTHER THAN FARM
 - SEASONAL OR SUMMER COLONY
 - DWELLING
 - CHURCH
 - CEMETERY
 - CHURCH WITH CEMETERY ADJACENT
- MISCELLANEOUS**
- TRIANGULATION STATION
 - DOT TO INDICATE LOCATION OF ANY CULTURAL FEATURE SHOWN OUT OF POSITION
 - ALL VACANT CULTURE INDICATED BY OPEN SYMBOL
 - LATITUDE AND LONGITUDE
- CITY AND VILLAGE CENTERS**
- COUNTY SEAT
 - OTHER CITIES AND VILLAGES
 - INCORPORATED CITY OR VILLAGE (GENERALIZED)

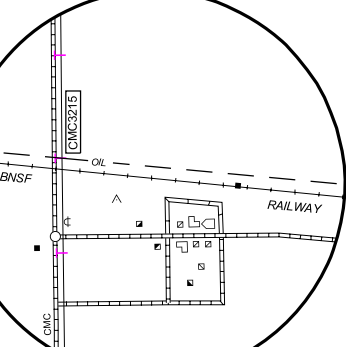
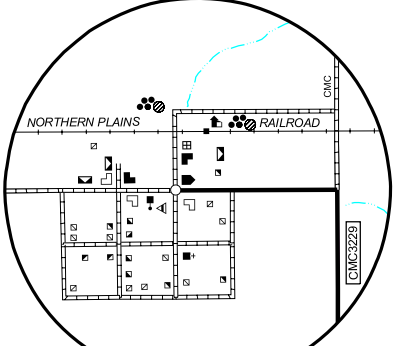
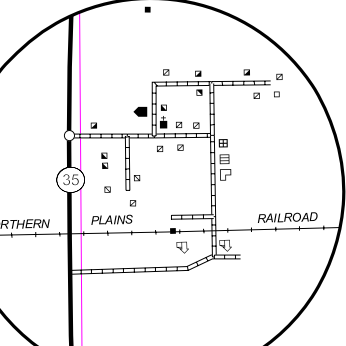
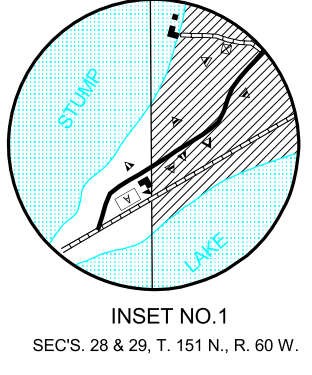
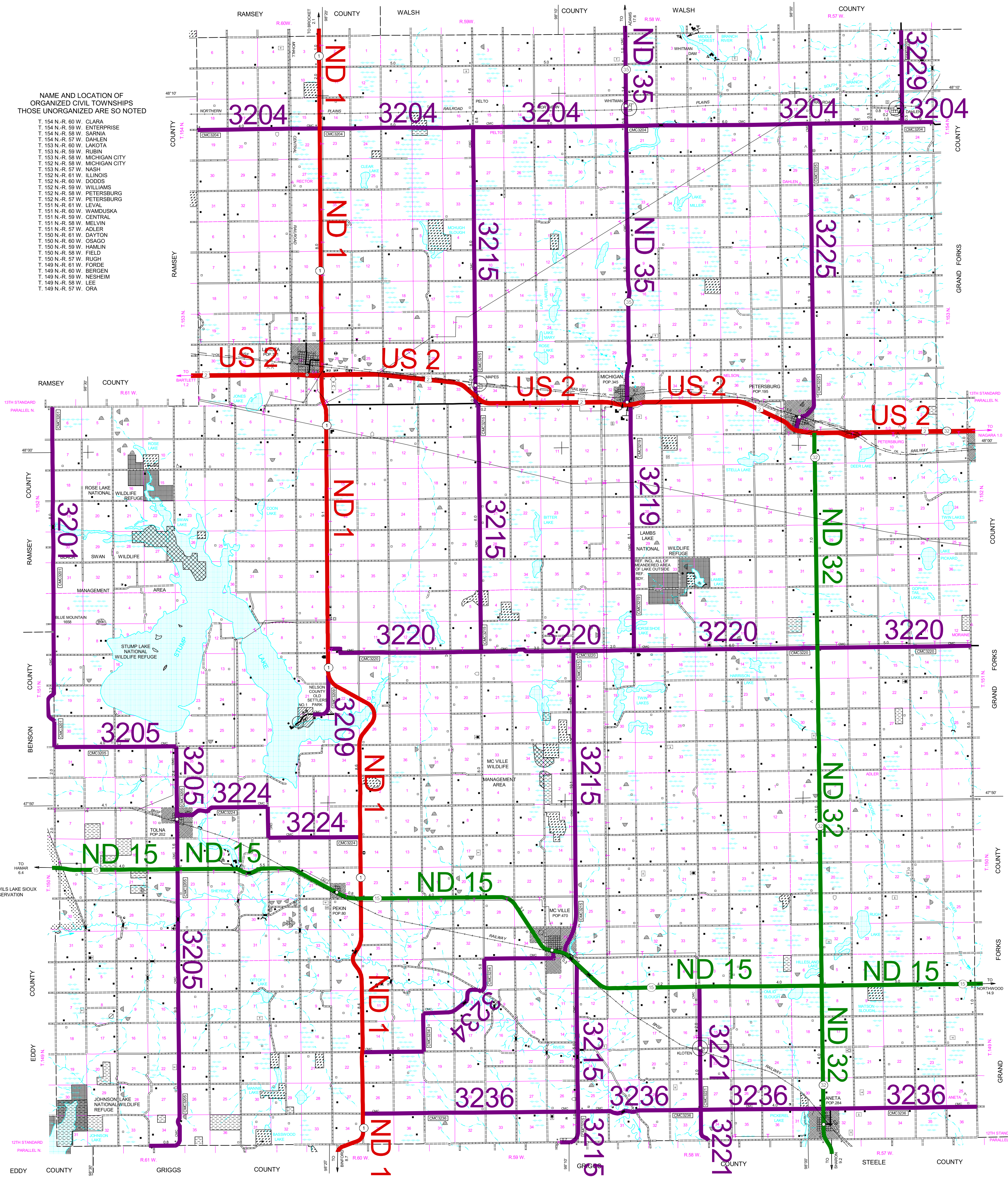
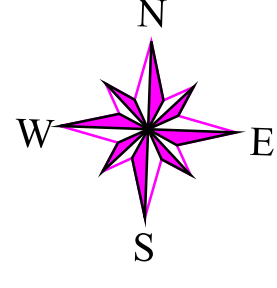

NELSON COUNTY NORTH DAKOTA

PREPARED BY THE
NORTH DAKOTA DEPARTMENT OF TRANSPORTATION
PLANNING AND PROGRAMMING DIVISION

IN COOPERATION WITH THE
U.S. DEPARTMENT OF TRANSPORTATION
FEDERAL HIGHWAY ADMINISTRATION

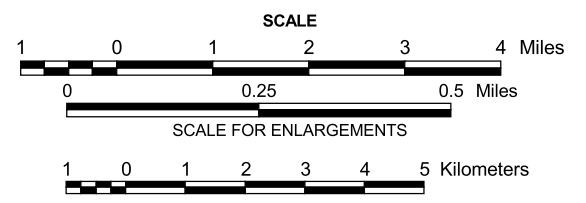

2006

BASED ON AERIAL PHOTOGRAPHY OF 1957
GROUND INVENTORY OF 2006
AERIAL INVENTORY OF 2006

UNIVERSAL TRANSVERSE MERCATOR ZONE 14
NORTH AMERICAN DATUM 83