

2007 FUNCTIONAL CLASSIFICATION

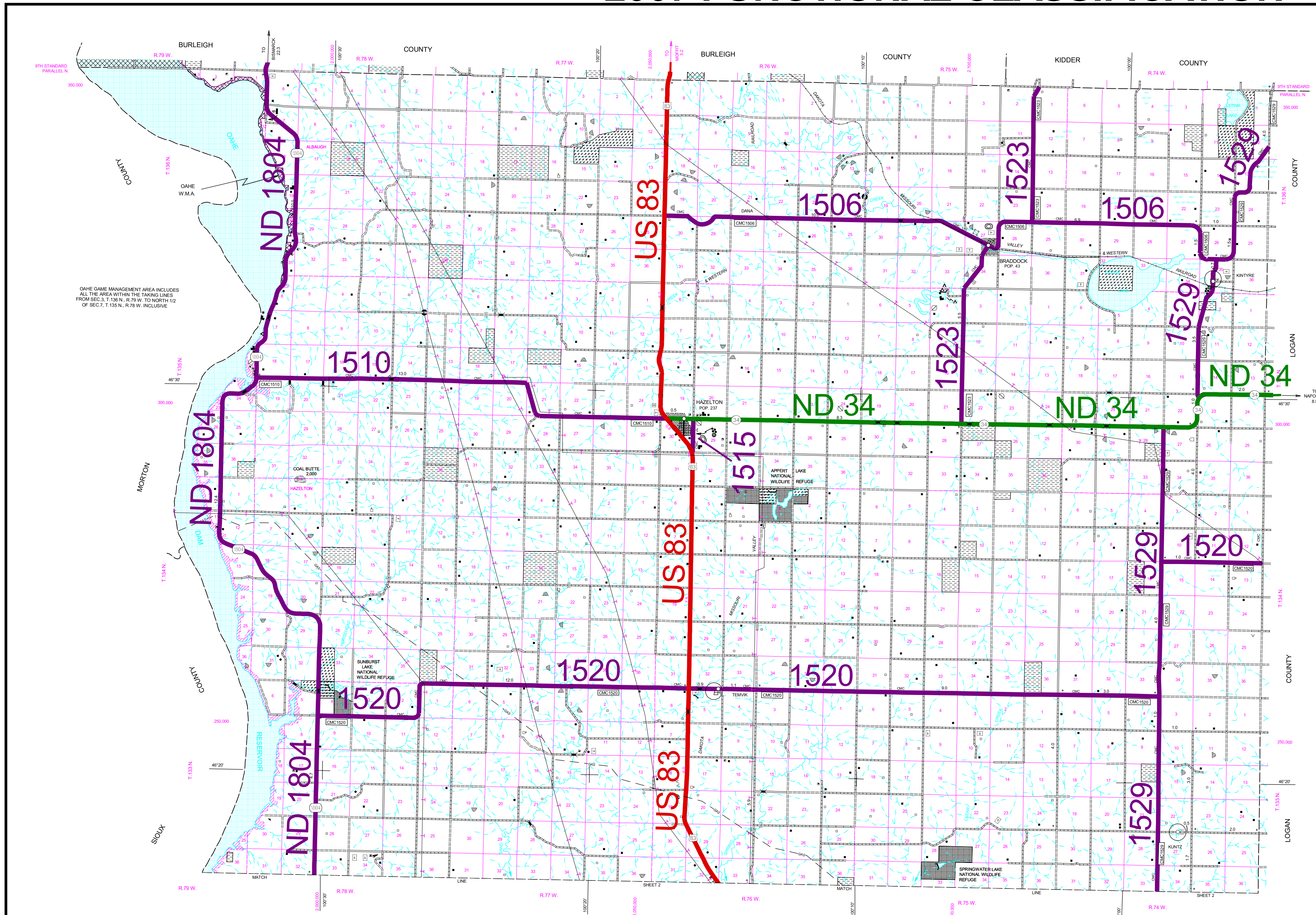

ROADS AND ROADWAY FEATURES		GENERAL LEGEND	
PRIMITIVE ROAD	STRUCTURES	
UNIMPROVED ROAD	HIGHWAY BRIDGE, GENERAL
GRADED AND DRAINED ROAD	DAM WITH ROAD
GRAVEL GRADED AND DRAINED ROAD	MINOR DRAINAGE STRUCTURE
PAVED ROAD	CONCRETE FORD OR DIP
COUNTY MAJOR COLLECTOR	FORD - ROAD ESTABLISHED
ROUTE NUMBER	NATURAL FEATURES	
POINTS BETWEEN WHICH DISTANCES ARE MEASURED	PROMINENT ELEVATION - WITH NAME
INTERSTATE NUMBERED HIGHWAY	BOUNDARIES	
U.S. NUMBERED HIGHWAY	STATE OR PROVINCE LINE
STATE HIGHWAY SYSTEM	COUNTY LINE
AIRPORTS		TOWNSHIP LINE
LANDING AREA OR STRIP	CORPORATE LINE
RAILROADS		SECTION LINE
RAILROAD (ANY NUMBER OF TRACKS USED BY A SINGLE OPERATING CO.)	MATCH LINE BETWEEN ADJOINING SHEETS OF SAME COUNTY
RAILROAD STATION	BOUNDARY TO MARK ENLARGEMENT INSET
RAILROAD STATION	NATIONAL REFUGES
WATERFOWL PRODUCTION AREA	WILDLIFE MANAGEMENT AREA
WATERFOWL PRODUCTION AREA	WATERFOWL PRODUCTION AREA
STATE SCHOOL LAND	RESERVOIR BOUNDARY (TAKING LINE)
CITY AND VILLAGE CENTERS		CITY SEAT
CITY SEAT	OTHER CITIES AND VILLAGES
INCORPORATED CITY OR VILLAGE (GENERALIZED)	INDUSTRIAL	
INDUSTRIAL		STORE OR SMALL BUSINESS ESTABLISHMENT
STORE OR SMALL BUSINESS ESTABLISHMENT	FACTORY OR INDUSTRIAL PLANT
FACTORY OR INDUSTRIAL PLANT	GROUP OF STORAGE TANKS (OIL OR GAS)
GROUP OF STORAGE TANKS (OIL OR GAS)	WAREHOUSE - GENERAL
WAREHOUSE - GENERAL	GRAIN ELEVATOR
GRAIN ELEVATOR	STOCK YARD - LOADING PEN OR CORRAL
STOCK YARD - LOADING PEN OR CORRAL	PIPE LINE, OIL
PIPE LINE, OIL	TRANSMISSION LINE
TRANSMISSION LINE	POWER SUBSTATION
POWER SUBSTATION	COMMUNICATION TOWER
COMMUNICATION TOWER		

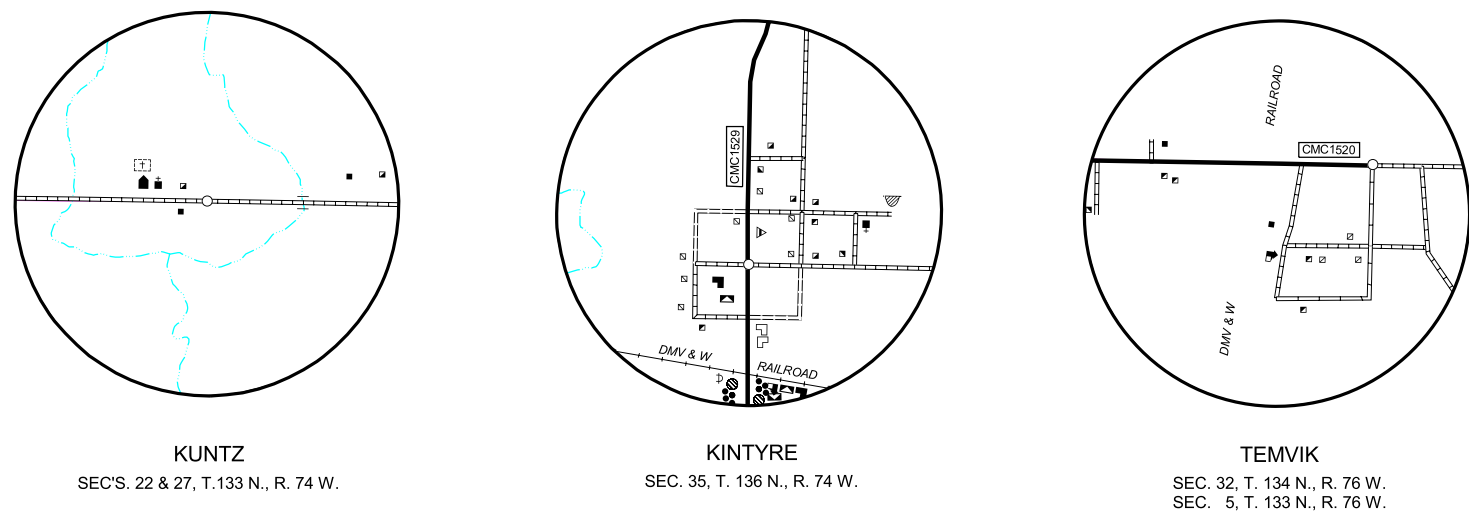

LEGEND	
	PRINCIPAL ARTERIALS
	MINOR ARTERIALS
	MAJOR COLLECTORS

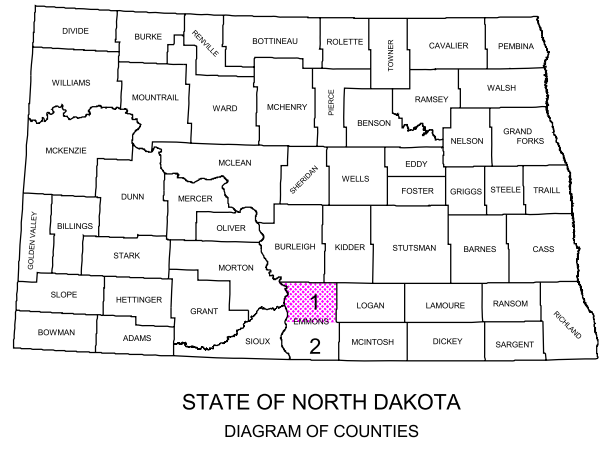

GENERAL HIGHWAY MAP EMMONS COUNTY NORTH DAKOTA

PREPARED BY THE
NORTH DAKOTA DEPARTMENT OF TRANSPORTATION
PLANNING AND PROGRAMMING DIVISION

IN COOPERATION WITH THE
U.S. DEPARTMENT OF TRANSPORTATION
FEDERAL HIGHWAY ADMINISTRATION

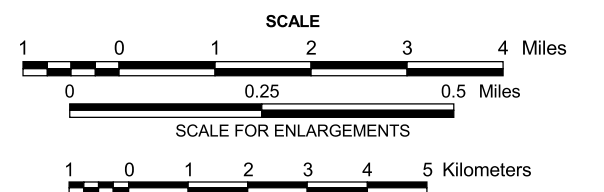

2002