

# GENERAL LEGEND

- OPEN STREETS & SECTION LINE ROADS
- RAILROADS
- RAILWAY CROSSING
- RAILWAY STATION
- COUNTY MAJOR COLLECTOR **CMC**
- INTERSTATE NUMBERED HIGHWAY
- U.S. NUMBERED HIGHWAY
- STATE HIGHWAY
- CORPORATE BOUNDARY

## CROSSING TYPE

- AUTOMATIC FLASHING **Y012**
- CROSS BUCKS **Y016**
- AUTOMATIC FLASHING WITH GATES **Y018**

Corporate limit updated from Cass County GIS website.

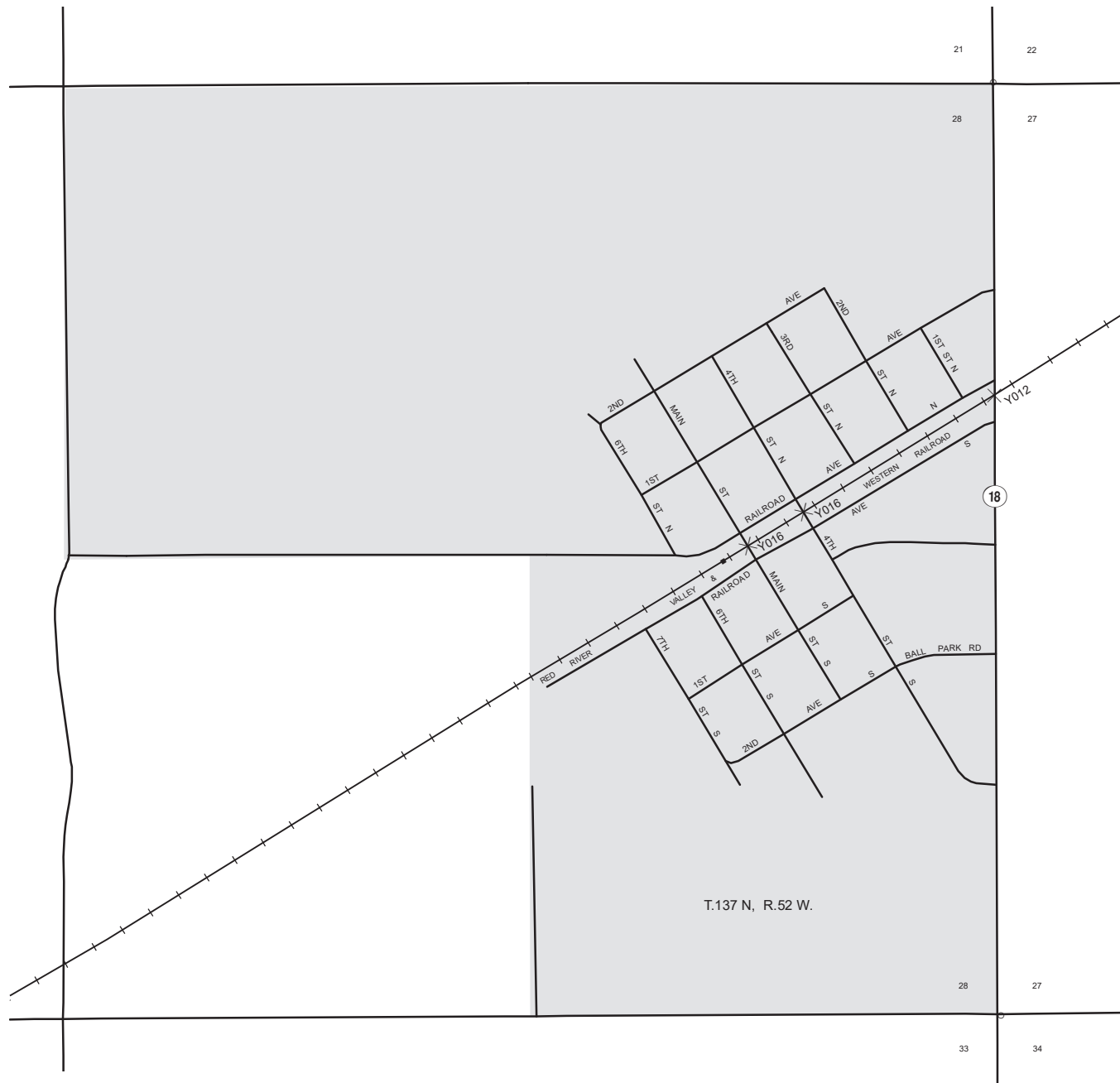

T.137 N, R.52 W.



2010 Population 223

# LEONARD

## CASS COUNTY

### NORTH DAKOTA

PREPARED BY  
 NORTH DAKOTA DEPARTMENT OF TRANSPORTATION  
 PLANNING / ASSET MANAGEMENT DIVISION  
 IN COOPERATION WITH THE  
 U.S. DEPARTMENT OF TRANSPORTATION  
 FEDERAL HIGHWAY ADMINISTRATION



2018

**Notice of Disclaimer**  
 The North Dakota Department of Transportation (NDDOT) makes this map available on an "as is" basis as a public service. Under no circumstances does NDDOT warrant or certify the information to be free of errors or deficiencies of any kind. NDDOT specifically disclaims all warranties, express or implied, including but not limited to the warranties of merchantability and fitness for a particular purpose.