

December 6, 2023

ADDENDUM 3 – JOB 23341

TO: All prospective bidders on Projects NH-9-999(477) and NH-7-002(172)053, Job No. 23341 scheduled for the December 8, 2023 bid opening.

The following revision(s) shall be made:

Plan Revisions:

See attached summary from Jason Thorenson, P.E. dated December 6, 2023 for an explanation.

This addendum is to be incorporated into the bidder's proposal for this project.



PHILLIP MURDOFF, P.E. – CONSTRUCTION SERVICES ENGINEER

80: jwj

Enclosure

PLAN ADDENDUM SUMMARY AND APPROVAL

PROJECT INFORMATION			
Project:	NH-7-002(172)053	PCN:	22605
Location:	CITY OF RAY - EB/WB		
Date:	12/6/2023	Lead Designer:	Kyle Evert
Bid Opening Date:	12/8/2023	JOB#:	23341
		Addendum#:	3

PLAN SHEET CHANGES		
Section	Sheet	Description
6	3	Added sheet 3
81	1	Added sheet 1
100	8-9	Added sheet 8 & 9

CHANGES MADE TO BID ITEMS FOR JOB					
Spec	Code	Description	Unit	Previous Quantity	Revised Quantity

APPROVAL

Should the revisions described above be processed as a plan addendum?

Yes No

 _____

12/06/23
Date

Jason Thorenson, P.E. – Bridge Engineer or

NOTES

STATE	PROJECT NO.	SECTION NO.	SHEET NO.
ND	NH-7-002(172)053	6	3

SECTION 100

202-P01 REMOVAL OF CONCRETE MEDIAN PAVEMENT: Saw cut and remove the existing pavement, base and earthen material to a depth of 9". The existing removal varies, as shown on Standard D-750-2, from 9" concrete thickness at the curb, to a material thickness of 4" thick concrete pavement, 4" thick base, and 1" earthen material. All cost of labor, equipment, and materials to perform work in the contract unit price bid for "Removal of Concrete Pavement."

764-P01 W-BEAM GUARDRAIL END TERMINALS FOR TWO-WAY TRAFFIC: Two W-beam guardrail end terminals are required for protection on the Burlington Northern RR Overhead, RP 53.731, roadway during two-way traffic operation.

For traffic on the north roadway install a W-beam terminal connector, a 12'-6" W-beam section (double thickness), two 12'-6" W-beam rail sections, and a W-beam guardrail end terminal, as shown in the plans. Install approximately 7.4 tons of 9" thick aggregate base course CL 5 in the area of the removed pavement. Approximately 4.1 tons of the aggregate base will be removed when the end terminal is removed to install concrete median pavement.

For traffic on the south roadway install a W-beam terminal connector, a 12'-6" W-beam section (double thickness), two 12'-6" W-beam rail sections, a rub rail and end shoe, as shown in the plans (and Standard Drawing D-764-9). Install approximately 8.2 tons of 9" thick aggregate base course CL 5 in the area of the removed pavement. Approximately 4.5 tons of the aggregate base will be removed when the end terminal is removed to install concrete median pavement.

The W-beam guardrail end terminals, additional guardrail materials, and the removed portions of aggregate base course CL 5, required for two-way traffic will remain the property of the contractor and be removed when no longer needed for two-way traffic operation.

The W-beam guardrail end terminals will be measured and paid for by the number of W-beam guardrail end terminals required and accepted by the engineer and include all materials; aggregate base course CL 5, W-beam terminal connector and W-beam rail sections, rub rail sections, end shoe, and all necessary posts, blocks, hardware, equipment, and labor.

SECTION 130

550-P01 CONCRETE MEDIAN PAVEMENT: The pavement depth varies from 9" to 4" as shown in the plans. Align the joints with the mainline joints. Include all costs to install the concrete, including sawing and sealing joints, in the contract unit price bid for the item "Concrete Median Pavement."



01/06/22

PRELIMINARY SURVEY COORDINATE AND CURVE DATA - City of Ray EB - WB

STATE	PROJECT NO.	SECTION NO.	SHEET NO.
ND	NH-7-002(172)053	81	1

HORIZONTAL ALIGNMENT				CURVE DATA		US PUBLIC LAND SURVEY DATA				SURVEY CONTROL POINTS					
PNT	STATION	NORTHING	EASTING	ARC DEFINITION		CORNER	IRN	NORTHING	EASTING	PNT	NORTHING	EASTING	ELEV	STATION	OFFSET
	Hwy 2 (Chain: EX_HWY2)			C501											
Begin	2809+06.19	500,996.38	1,318,487.63	PI STA = 2833+35.00											
PC	2832+39.02	500,912.06	1,320,818.94	Delta = 7° 36' 27" RT											
PI C501	2833+35.00	500,908.59	1,320,914.85	D _a = 3° 58' 09"											
PT	2834+30.70	500,892.45	1,321,009.46	R = 1,443.57'											
PC	2840+51.49	500,788.08	1,321,621.42	T = 95.98'											
PI C502	2841+54.75	500,770.72	1,321,723.21	L = 191.67'											
PT	2842+57.45	500,771.83	1,321,826.46												
PC	2862+47.79	500,793.22	1,323,816.69												
PI C503	2866+00.54	500,797.01	1,324,169.42	C502											
PT	2869+53.06	500,822.49	1,324,521.24	PI STA = 2841+54.75											
End	2873+96.79	500,854.54	1,324,963.80	Delta = 10° 17' 41" LT											
				D _a = 4° 59' 54"											
				R = 1,146.28'											
				T = 103.26'											
				L = 205.96'											
				C503											
				PI STA = 2866+00.54											
				Delta = 3° 31' 35" LT											
				D _a = 0° 30' 00"											
				R = 11,459.16'											
				T = 352.74'											
				L = 705.27'											

PRIMARY CONTROL					
RTK 50000	501,239.84	1,313,243.46	2,313.41	N/A	N/A
1.5" Alum cap					
RTK 50001	500,722.70	1,325,081.06	2,272.39	N/A	N/A
#4 Rebar					

REFERENCE MARKERS					
R Mkr #	NORTHING	EASTING	STATION	OFFSET	ALIGNMENT
RM54	500,834.43	1,322,259.35	N/A	58' Lt	EX_HWY2
RM54	500,718.38	1,322,263.02	N/A	58' Rt	EX_HWY2
RM55	500,703.48	1,327,618.58	N/A	N/A	EX_HWY2
RM55	500,855.36	1,327,620.45	N/A	N/A	EX_HWY2

NOTES: Alignment per NDDOT Proj# 7-002(119)053

Date Survey Completed 06/02/2021

- Assumed Coordinates
- All coordinates on this sheet are Williams County ground coordinates. They are derived from the NAD83(2011) reference frame; North Dakota North Zone Combination Factor (cf) = 0.9998445

All coordinates and measurements on this document derived from the International Foot definition.

- INITIALIZING BENCH MARK NDGPS Stations (OPUS)
- NAVD-88
- _____
- GEOID12B _____
- GEOID18



SPEC	CODE	BID ITEM	QTY	UNIT	SPEC	CODE	BID ITEM	QTY	UNIT
202	0114	REMOVAL OF CONCRETE PAVEMENT	35.6	SY	764	0145	W-BEAM GUARDRAIL END TERMINAL	1	EA

23 USC § 409 Documents
NDDOT Reserves All Objections

STATE	PROJECT NO.	SECTION NO.	SHEET NO.
ND	NH-7-002(172)053	100	8

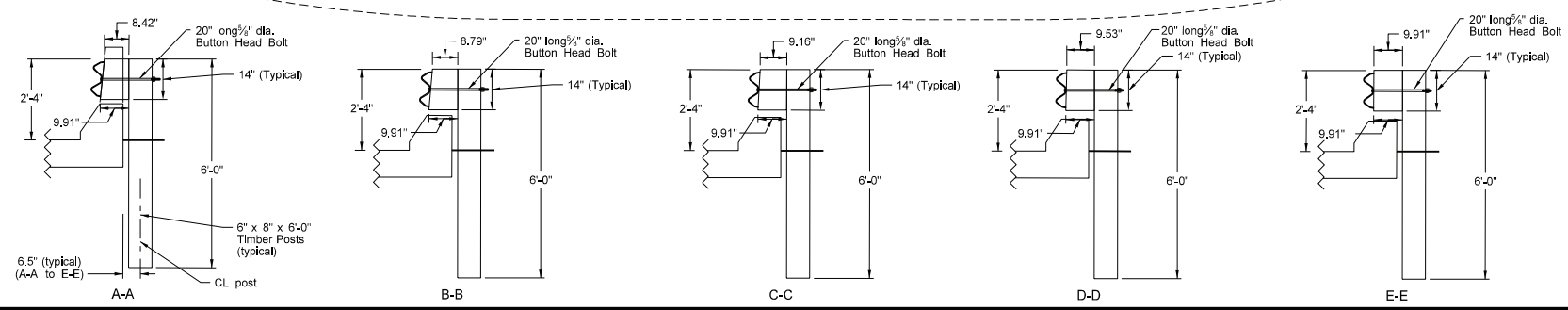
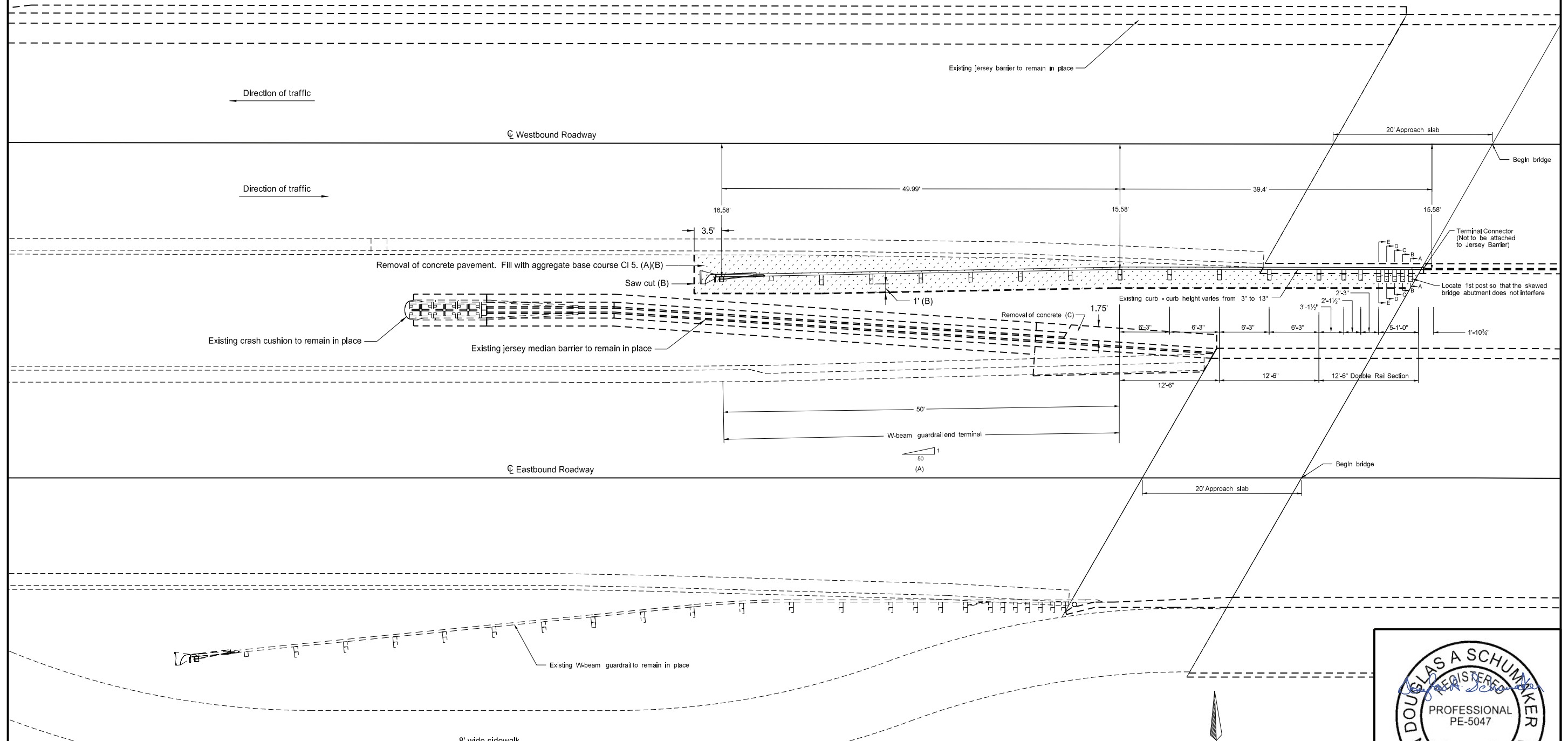

- (A) Install an SKT end terminal at this location. See Standard D-764-5.
Include all costs to install 9" aggregate base course CL 5 (approximately 7.4 ton) and then remove a portion of the base to install concrete median pavement when the end terminal is removed (approximately 4.1 ton - See Section 130) in the contract unit price bid for "W-BEAM GUARDRAIL END TERMINAL."
- (B) Saw cut at 1" (Min) from the back of the guardrail posts. Pavement thickness varies from 9" at the curb to 4". See Standard D-750-2.
- (C) Include all costs to remove the concrete jersey median barrier (including the 1' depth foundation slab) adjacent to the new approach slab, and to install 8" foundation fill in this area, in the contract unit cost bid for "BRIDGE APPROACH SLAB-REMOVE & REPLACE"



W-Beam Guardrail End Terminals
For Two-Way Traffic Operation
On North Roadway (Phase 1)

West End of Burlington Northern RR Overhead
RP 53.731

US 2

23 USC § 409 Documents
 NDDOT Reserves All Objections

STATE	PROJECT NO.	SECTION NO.	SHEET NO.
ND	NH-7-002(172)053	100	9

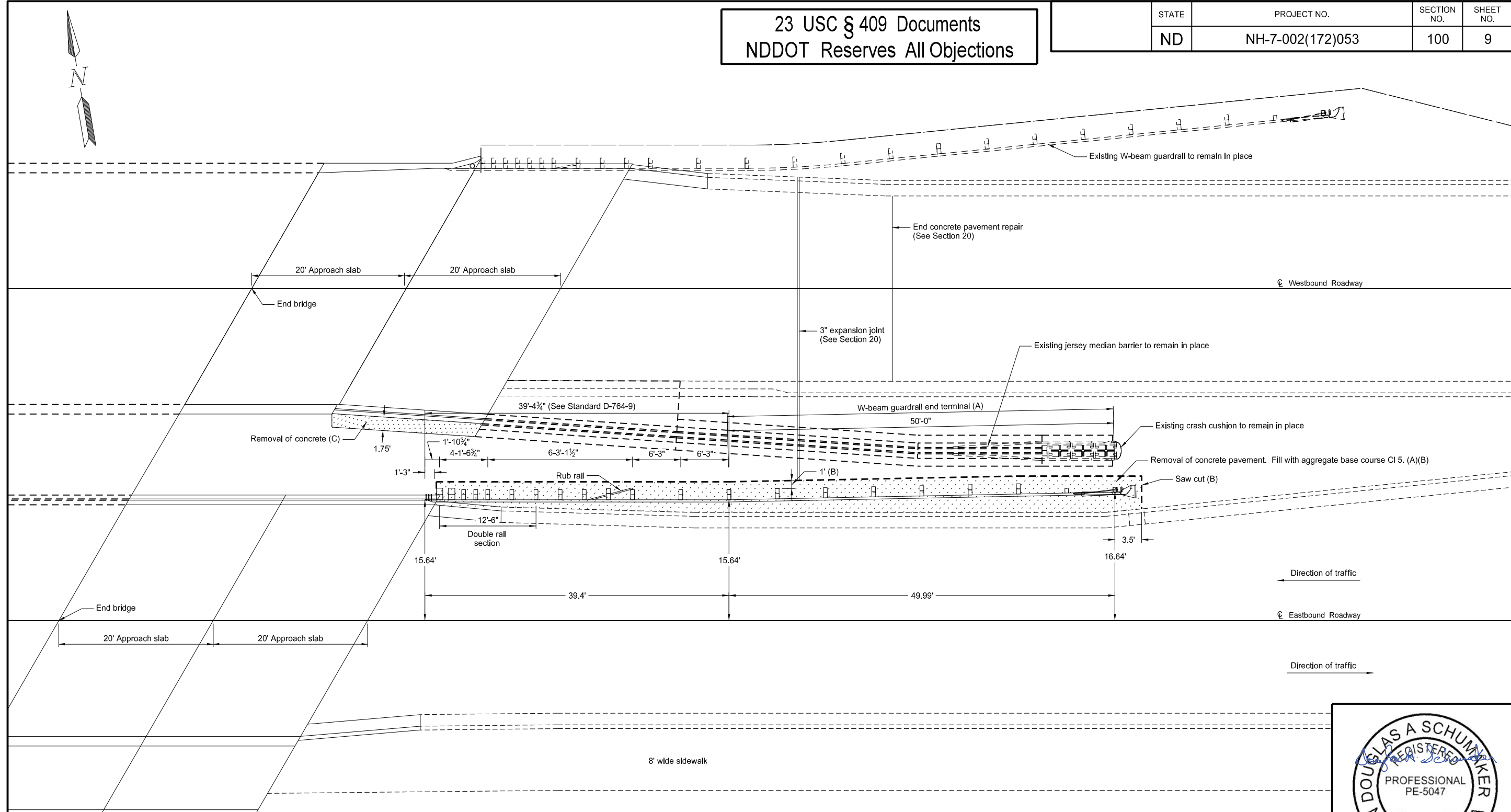

- (A) Install an SKT end terminal at this location. See Standard D-764-5.
 Include all costs to install 9" aggregate base course CL 5 (approximately 8.2 ton) and then remove a portion of the base to install concrete median pavement when the end terminal is removed (approximately 4.5 ton - See Section 130) in the contract unit price bid for "W-BEAM GUARDRAIL END TERMINAL."
- (B) Saw cut at 1' (Min) from the back of the guardrail posts. Pavement thickness varies from 9" at the curb to 4". See Standard D-750-2.
- (C) Include all costs to remove the concrete jersey median barrier (including the 1' depth foundation slab) adjacent to the new approach slab, and to install 8" foundation fill in this area, in the contract unit cost bid for "BRIDGE APPROACH SLAB-REMOVE & REPLACE."

SPEC	CODE	BID ITEM	QTY	UNIT
202	0114	REMOVAL OF CONCRETE PAVEMENT	39.4	SY
764	0145	W-BEAM GUARDRAIL END TERMINAL	1	EA

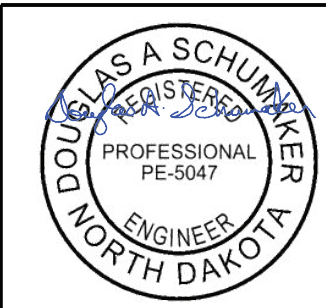

01/06/22

W-Beam Guardrail End Terminals
 For Two-Way Traffic Operation
 On South Roadway (Phase 2)
 East End of Burlington Northern RR Overhead
 RP 53.731
 US 2