

INSET NO. 3
SEC'S. 16, 17, 20, & 21, T. 153 N., R. 64 W.

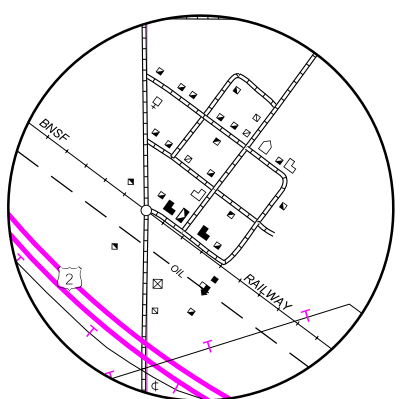

PENN
SEC'S. 25 & 26, T. 155 N., R. 66 W.

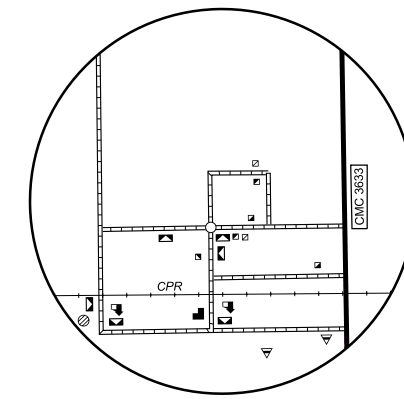

SOUTHAM
SEC'S. 13, 14, 15, 16, 17, 18, 19, 20, 21, 22, T. 154 N., R. 62 W.

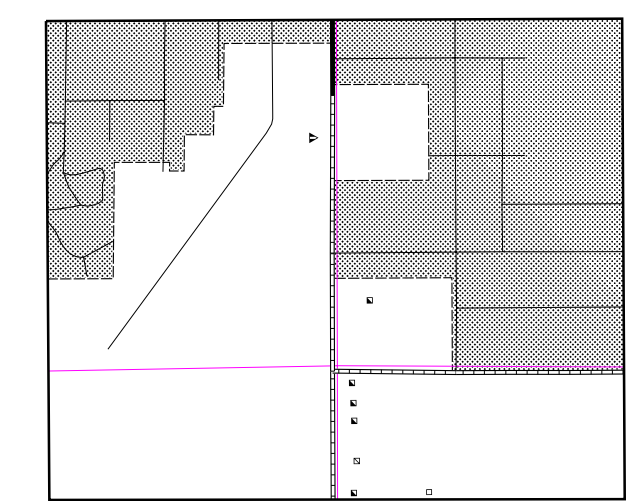

DEVILS LAKE NO. 1
SEC'S. 2, 3, 10, & 11, T. 153 N., R. 64 W.

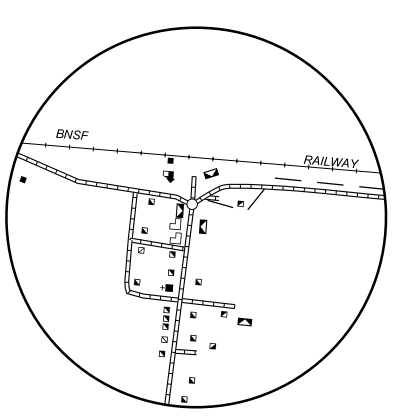

DOYON
SEC. 19, T. 153 N., R. 61 W.

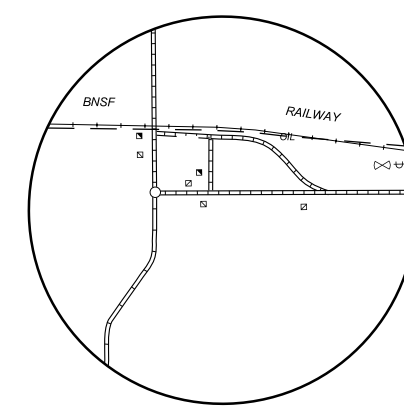

BARTLETT
SEC'S. 25, 26, T. 153 N., R. 61 W.

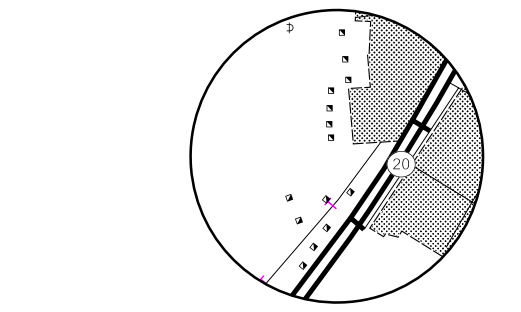

DEVILS LAKE NO. 2
SEC. 3, T. 153 N., R. 64 W.

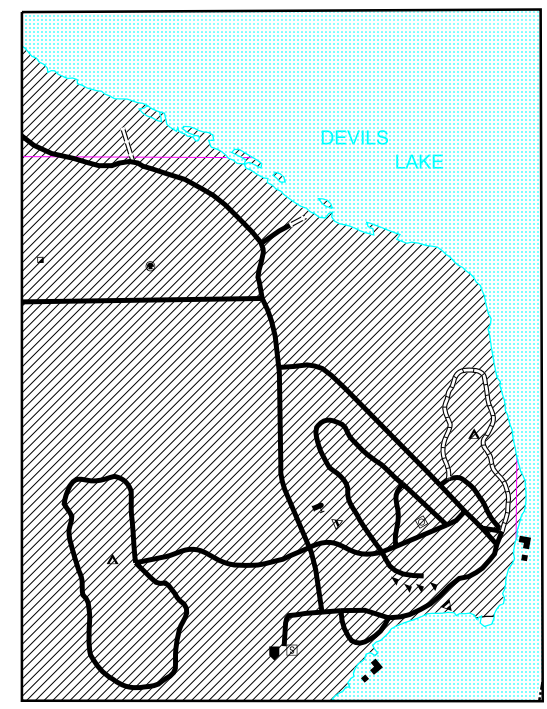

GRAHAM'S ISLAND STATE PARK INSET
SEC'S. 19, 20, 29, & 30, T. 153 N., R. 65 W.

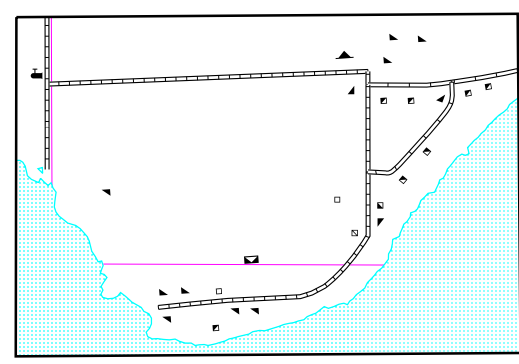

INSET NO. 7
SEC'S. 14 & 23, T. 153 N., R. 65 W.

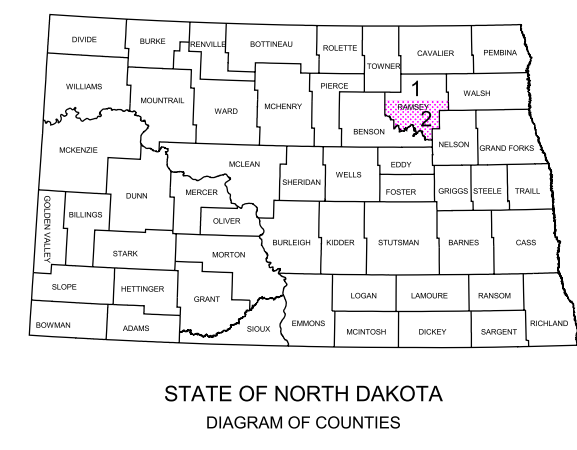

STATE OF NORTH DAKOTA
DIAGRAM OF COUNTIES

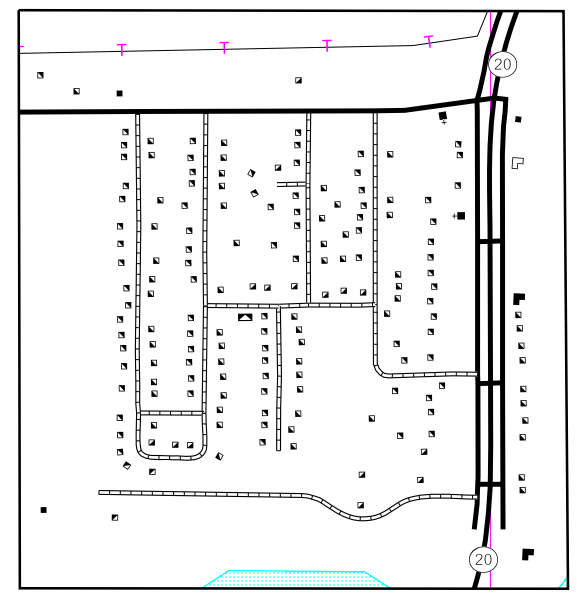

INSET NO. 2
SEC'S. 9 & 10, T. 153 N., R. 64 W.

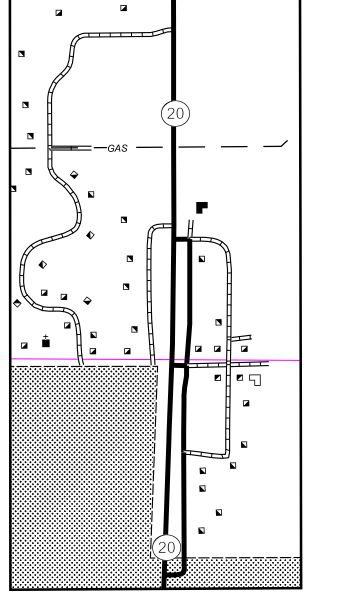

INSET NO. 1
SEC'S. 22 & 27, T. 154 N., R. 64 W.

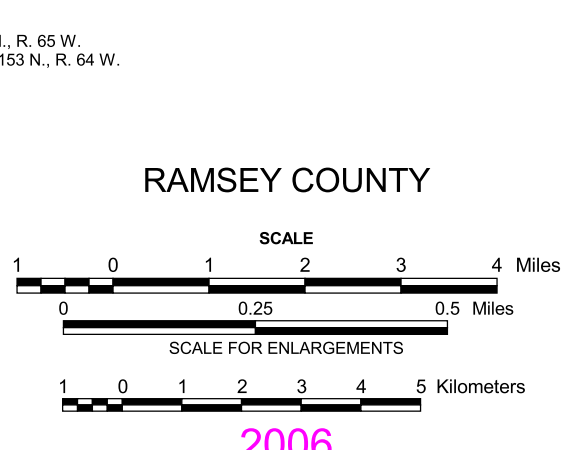
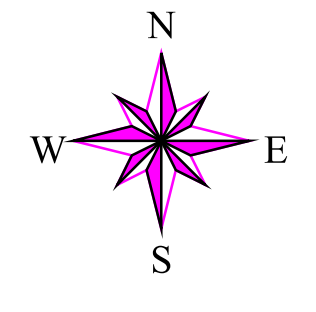
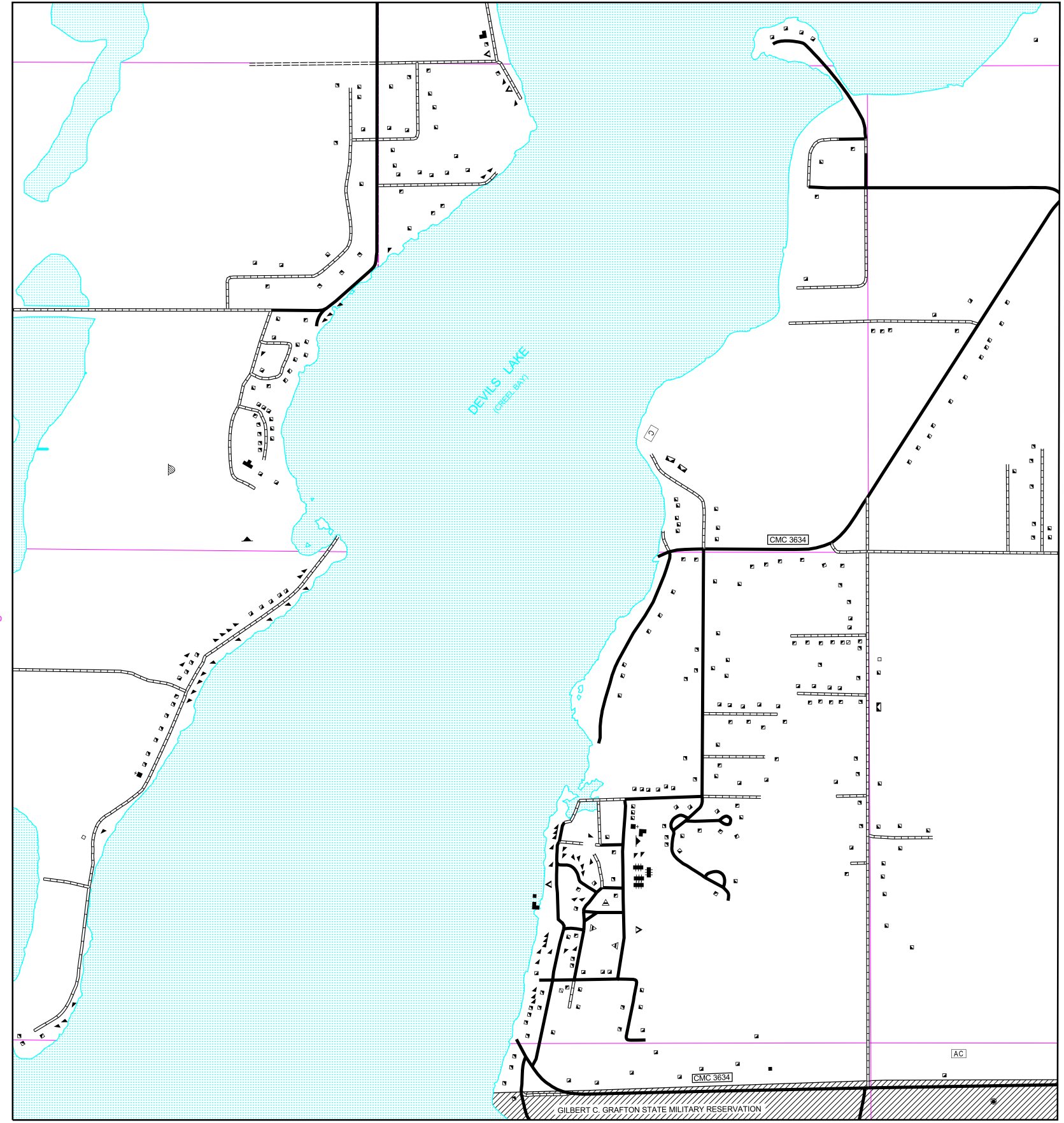

RAMSEY COUNTY
SCALE
0 1 2 3 4 Miles
0 0.25 0.5 Miles
SCALE FOR ENLARGEMENTS
0 1 2 3 4 5 Kilometers
2006

COPIES OF THIS MAP ARE AVAILABLE FOR PUBLIC USE AT A NOMINAL COST FROM:
MAP SALES, N.D. DEPT. OF TRANSPORTATION, 608 E. BLVD. AVE., BISMARCK, N.D. 58505-0700

BASED ON AERIAL PHOTOGRAPHY OF 1959
GROUND INVENTORY OF 2006
AERIAL INVENTORY OF 2006

UNIVERSAL TRANSVERSE MERCATOR ZONE 14
NORTH AMERICAN DATUM 83
SHEET 2 OF 2